

F.L MOFFETT PRIMARY SCHOOL
CENTER ELEMENTARY SCHOOL
CENTER INTERMEDIATE SCHOOL



Preparing Students

for

Their Future

School Information

Center Intermediate School

624 Malone Drive

Center, Texas 75935

(936) 598-6148

Center Elementary School

621 Roughrider Drive

Center, Texas 75935

(936) 598-3625

F.L. Moffett Primary School

294 Stadium Drive

Center, Texas 75935

(936) 598-6266

FOREWORD

It is indeed a pleasure to welcome you to Center Schools. Our desire is that this will be your most productive school year. This handbook has been prepared so that all students, teachers, and parents will know and understand the policies of the school. Cooperation is essential if we are to have a good school. Indeed, a school will be as good for each student as the effort he/she puts into it. Working together, each meeting his/her personal responsibilities, we will have a school in which you will be safe, happy, and proud; and our accomplishments will be noteworthy.

Center Independent School District

Mission Statements

Center ISD recognizes that each student has individual needs and that all students are diverse learners. As a result, the mission of Center ISD is to challenge each student to reach his or her intellectual, creative, and physical potential by providing a fully integrated curriculum and rigorous instruction. In doing so, Center ISD will provide a nurturing learning environment that empowers all stakeholders to become confident, creative designers of their future and will provide opportunities for collaboration to develop respect for individual differences and community values.

Center Independent School District

Vision:

Preparing Students for Their Future

Table of Contents

PREFACE.....	1
SECTION I: PARENTAL RIGHTS AND RESPONSIBILITIES	2
PARENTAL INVOLVEMENT.....	2
Working Together.....	2
Parent Involvement Coordinator.....	3
PARENTAL RIGHTS	3
Obtaining Information and Protecting Student Rights.....	3
“Opting Out” of Surveys and Activities	3
Inspecting Surveys	4
Requesting Professional Qualifications of Teachers and Staff.....	4
Reviewing Instructional Materials	4
Displaying a Student’s Artwork and Projects.....	4
Accessing Student Records.....	4
Granting Permission to Video or Audio Record a Student.....	5
Granting Permission to Receive Parenting and Paternity Awareness Instruction	5
Removing a Student Temporarily from the Classroom	5
Excusing a Student from Reciting the Pledges to the U.S. and Texas Flags	5
Excusing a Student from Reciting a Portion of the Declaration of Independence	5
Requesting Limited or No Contact with a Student through Electronic Media.....	5
Requesting Notices of Certain Student Misconduct	6
School Safety Transfers	6
Requesting Classroom Assignment for Multiple Birth Siblings.....	6
Parents of Students with Disabilities	6
Request for the Use of a Service Animal.....	6
Options and Requirements for Providing Assistance to Students Who Have Learning Difficulties or Who Need or May Need Special Education Services	7
Parents of Students who speak a Primary Language Other than English.....	7
Accommodations for Children of Military Families	7
Student Records	8
Directory Information	10

SECTION II: OTHER IMPORTANT INFORMATION FOR STUDENTS AND PARENTS..	11
ABSENCES/ATTENDANCE	11
Compulsory Attendance.....	11
Exemptions to Compulsory Attendance	11
Failure to Comply with Compulsory Attendance	12
Attendance for Credit.....	12
Parent’s Note after an Absence.....	13
Doctor’s Note after an Absence for Illness.....	13
BULLYING	14
CHILD SEXUAL ABUSE	14
CLASS SCHEDULES	15
COMPLAINTS AND CONCERNS	15
CONDUCT	16
Applicability of School Rules.....	16
Corporal Punishment	16
Disruptions of School Operations.....	16
Social Events.....	16
CONTAGIOUS DISEASES / CONDITIONS	17
Personal Counseling.....	17
Psychological Exams, Tests, or Treatment.....	17
CREDIT BY EXAM—If a Student Has Taken the Course.....	17
CREDIT BY EXAM—If a Student Has Not Taken the Course.....	18
DATING VIOLENCE, DISCRIMINATION, HARASSMENT, AND RETALIATION	18
Discrimination.....	18
Harassment.....	18
Sexual Harassment.....	19
Retaliation.....	19
Reporting Procedures.....	19
Investigation of Report	19
DISTRIBUTION OF PUBLISHED MATERIALS OR DOCUMENTS	20
School Materials	20
Nonschool Materials...from students	20
Nonschool Materials...from others.....	20
DRESS AND GROOMING	21

ELECTRONIC DEVICES AND TECHNOLOGY RESOURCES.....	22
Possession and Use of Personal Telecommunications Devices, Including Mobile Telephones	22
Possession and Use of Other Personal Electronic Devices.....	22
Instructional Use of Personal Telecommunications and Other Electronic Devices	22
Acceptable Use of District Technology Resources	23
Unacceptable and Inappropriate Use of Technology Resources	23
EXTRACURRICULAR ACTIVITIES, CLUBS, AND ORGANIZATIONS	24
Standards of Behavior.....	24
FEES	24
FUND-RAISING	25
GANG-FREE ZONES	25
GRADING GUIDELINES	26
HARASSMENT	26
HAZING	27
HEALTH-RELATED MATTERS	27
Bacterial Meningitis.....	27
Physical Activity for Students in Elementary and Middle School	28
School Health Advisory Council (SHAC).....	29
Other Health-Related Matters	29
Physical Fitness Assessment.....	29
Vending Machines	29
Tobacco Prohibited	29
Asbestos Management Plan	29
Pest Management Plan.....	29
HOMELESS STUDENTS	30
HOMEWORK.....	30
IMMUNIZATION	30
LAW ENFORCEMENT AGENCIES	31
Questioning of Students	31
Students Taken Into Custody	31
Notification of Law Violations	31
LIMITED ENGLISH PROFICIENT STUDENTS	32
MAKEUP WORK	32
Makeup Work Because of Absence	32

In-school Suspension (ISS) Makeup Work.....	33
MEDICINE AT SCHOOL.....	33
NONDISCRIMINATION STATEMENT.....	34
PLEDGES OF ALLEGIANCE AND A MINUTE OF SILENCE.....	34
PRAYER.....	34
PROMOTION AND RETENTION.....	35
RELEASE OF STUDENTS FROM SCHOOL.....	36
REPORT CARDS / PROGRESS REPORTS AND CONFERENCES.....	36
SAFETY.....	37
Accident Insurance.....	37
Drills: Fire, Tornado, and Other Emergencies.....	37
Emergency Medical Treatment and Information.....	37
Emergency School-Closing Information.....	37
SCHOOL FACILITIES.....	38
Conduct Before and After School.....	38
Use of Hallways During Class Time.....	38
Cafeteria Services.....	38
Library.....	38
Meetings of Noncurriculum-Related Groups.....	39
SEARCHES.....	39
Students' Desks and Lockers.....	39
Electronic Devices.....	39
SPECIAL PROGRAMS.....	39
STANDARDIZED TESTING.....	39
STAAR (State of Texas Assessments of Academic Readiness).....	40
Grades 3–8.....	40
TARDINESS.....	41
TEXTBOOKS, ELECTRONIC TEXTBOOKS, AND TECHNOLOGICAL EQUIPMENT..	41
TRANSFERS.....	41
TRANSPORTATION.....	42
School-Sponsored Trips.....	42
Buses and Other School Vehicles.....	42
VANDALISM.....	43
VIDEO CAMERAS.....	43

VISITORS TO THE SCHOOL	43
General Visitors	43
WITHDRAWING FROM SCHOOL	43
Glossary	44
APPENDIX I: G.T	47
APPENDIX II: Campus maps.....	49
APPENDIX III: Parental Involvement Policy.....	50
APPENDIX IV: Corporal Punishment.....	59
APPENDIX V: Grading Policy.....	60

PREFACE

To Students and Parents:

Welcome to school year 2011–2012! Education is a team effort, and we know that students, parents, teachers, and other staff members all working together can make this a wonderfully successful year for our students.

The Student Handbook for the Center Elementary campuses is designed to provide a resource for some of the basic information that you and your child will need during the school year. In an effort to make it easier to use, the handbook is divided into two sections:

Section I—PARENTAL RIGHTS AND RESPONSIBILITIES—with information to assist you in responding to school-related issues. We encourage you to take some time to closely review this section of the handbook.

Section II—OTHER IMPORTANT INFORMATION FOR STUDENTS AND PARENTS—organized alphabetically by topic for quick access when searching for information on a specific issue.

Please be aware that the term “the student’s parent” is used to refer to the parent, legal guardian, or any other person who has agreed to assume school-related responsibility for a student.

Both students and parents should become familiar with the Center Student Code of Conduct, which is a document adopted by the board and intended to promote school safety and an atmosphere for learning. That document may be found as an attachment to this handbook and available in the principal’s office.

The Student Handbook is designed to be in harmony with board policy and the Student Code of Conduct. Please be aware that the handbook is updated yearly, while policy adoption and revision may occur throughout the year. Changes in policy or other rules that affect Student Handbook provisions will be made available to students and parents through newsletters or other communications.

In case of conflict between board policy (including the Student Code of Conduct) and any provisions of the Student Handbook, the current provisions of board policy and the Student Code of Conduct are to be followed.

After reading through the entire handbook with your child, keep it as a reference during this school year. If you or your child have questions about any of the material in this handbook, please contact a teacher, the counselor, or the principal.

Also, please complete and return the following documents to your child’s school:

1. Parental Acknowledgment Form;
2. Student Directory Information and Release of Student Information Form;

These forms can be found in the beginning of the year packet.

See **Obtaining Information and Protecting Student Rights** and **Directory Information** on student beginning of the year packet for more information.

Please note that references to policy codes are included so that parents can refer to current board policy. A copy of the district's policy manual is available for review in the school office or online at www.centerisd.org.

SECTION I: PARENTAL RIGHTS AND RESPONSIBILITIES

This section of the Center Student Handbook includes information on topics of particular interest to you as a parent.

PARENTAL INVOLVEMENT

Working Together

Both experience and research tell us that a child's education succeeds best when there is good communication and a strong partnership between home and school. Your involvement in this partnership may include:

- Encouraging your child to put a high priority on education and working with your child on a daily basis to make the most of the educational opportunities the school provides.
- Ensuring that your child completes all homework assignments and special projects and comes to school each day prepared, rested, and ready to learn.
- Becoming familiar with all of your child's school activities and with the academic programs, including special programs, offered in the district.
- Discussing with the counselor or principal any questions you may have about the options and opportunities available to your child.
- Reviewing the requirements of the graduation programs with your child once your child begins enrolling in courses that earn high school credit.
- Monitoring your child's academic progress and contacting teachers as needed. See **Academic Counseling** on page 18.
- Attending scheduled conferences and requesting additional conferences as needed. To schedule a telephone or in-person conference with a teacher, counselor, or principal, please call the school office at FLM (598-6266), CES(598-3625), CIS(598-6148) for an appointment. The teacher will usually return your call or meet with you during his or her conference period or before or after school.
- Becoming a school volunteer. For further information, see policies at GKG (www.centerisd.org) or contact your child's school office.
- Serving as a parent representative on the district-level or campus-level planning committees, assisting in the development of educational goals and plans to improve student achievement. For further information, see policies at BQA and BQB, and contact Dr. Daya Hill at 598-5642.
- Serving on the School Health Advisory Council (SHAC), assisting the district in ensuring local community values are reflected in health education instruction. [See policies at BDF, EHAA, FFA, and information in this handbook at **School Health Advisory Council** contact Angela Lawson at 598-7291].

- Attending board meetings to learn more about district operations. [See policies at BE and BED for more information.]

Parent Involvement Coordinator

The Parent Involvement Coordinator, who works with parents of students participating in Title I programs is Angela Lawson and may be contacted at 598-7291.

PARENTAL RIGHTS

Obtaining Information and Protecting Student Rights

Your child will not be required to participate without parental consent in any survey, analysis, or evaluation—funded in whole or in part by the U.S. Department of Education—that concerns:

- Political affiliations or beliefs of the student or the student’s parent.
- Mental or psychological problems of the student or the student’s family.
- Sexual behavior or attitudes.
- Illegal, antisocial, self-incriminating, or demeaning behavior.
- Critical appraisals of individuals with whom the student has a close family relationship.
- Relationships privileged under law, such as relationships with lawyers, physicians, and ministers.
- Religious practices, affiliations, or beliefs of the student or parents.
- Income, except when the information is required by law and will be used to determine the student’s eligibility to participate in a special program or to receive financial assistance under such a program.

You will be able to inspect the survey or other instrument and any instructional materials used in connection with such a survey, analysis, or evaluation. [For further information, see policy EF (LEGAL) (www.centerisd.org).]

“Opting Out” of Surveys and Activities

As a parent, you have a right to receive notice of and deny permission for your child’s participation in:

- Any survey concerning the private information listed above, regardless of funding.
- School activities involving the collection, disclosure, or use of personal information gathered from your child for the purpose of marketing or selling that information.
- Any nonemergency, invasive physical examination or screening required as a condition of attendance, administered and scheduled by the school in advance and not necessary to protect the immediate health and safety of the student. Exceptions are hearing, vision, or scoliosis screenings, or any physical exam or screening permitted or required under state law. [See policies EF and FFAA. (www.centerisd.org)]

Inspecting Surveys

As a parent, you may inspect a survey created by a third party before the survey is administered or distributed to your child.

Requesting Professional Qualifications of Teachers and Staff

You may request information regarding the professional qualifications of your child's teachers, including whether a teacher has met state qualification and licensing criteria for the grade levels and subject areas in which the teacher provides instruction; whether the teacher has an emergency permit or other provisional status for which state requirements have been waived; and undergraduate and graduate degree majors, graduate certifications, and the field of study of the certification or degree. You also have the right to request information about the qualifications of any paraprofessional who may provide services to your child.

Reviewing Instructional Materials

As a parent, you have a right to review teaching materials, textbooks, and other teaching aids and instructional materials used in the curriculum, and to examine tests that have been administered to your child.

Displaying a Student's Artwork and Projects

Teachers may display students' work in classrooms or elsewhere on campus as recognition of student achievement. However, the district will seek parental consent before displaying students' artwork, special projects, photographs taken by students, and the like on the district's Web site, in printed material, by video, or by any other method of mass communication.

Accessing Student Records

You may review your child's student records. These records include:

- Attendance records,
- Test scores,
- Grades,
- Disciplinary records,
- Counseling records,
- Psychological records,
- Applications for admission,
- Health and immunization information,
- Other medical records,
- Teacher and counselor evaluations,
- Reports of behavioral patterns, and
- State assessment instruments that have been administered to your child.

[See **Student Records** on page 8.]

Granting Permission to Video or Audio Record a Student

As a parent, you may grant or deny any written request from the district to make a video or voice recording of your child. State law, however, permits the school to make a video or voice recording without parental permission for the following circumstances:

- When it is to be used for school safety;
- When it relates to classroom instruction or a cocurricular or extracurricular activity; or
- When it relates to media coverage of the school.

Granting Permission to Receive Parenting and Paternity Awareness Instruction

As a parent, if your child is under the age of 14, you must grant permission for your child to receive instruction in the district's parenting and paternity awareness program or your child will not be allowed to participate in the instruction. This program, developed by the Office of the Texas Attorney General and the State Board of Education (SBOE), is incorporated into the district's health education classes.

Removing a Student Temporarily from the Classroom

You may remove your child temporarily from the classroom if an instructional activity in which your child is scheduled to participate conflicts with your religious or moral beliefs. The removal cannot be for the purpose of avoiding a test and may not extend for an entire semester. Further, your child must satisfy grade-level and graduation requirements as determined by the school and by the Texas Education Agency.

Excusing a Student from Reciting the Pledges to the U.S. and Texas Flags

As a parent, you may request that your child be excused from participation in the daily recitation of the Pledge of Allegiance to the United States flag and the Pledge of Allegiance to the Texas flag. The request must be in writing. State law does not allow your child to be excused from participation in the required minute of silence or silent activity that follows. [See **Pledges of Allegiance and a Minute of Silence** on page 34 and policy EC(LEGAL). (www.centerisd.org)]

Excusing a Student from Reciting a Portion of the Declaration of Independence

You may request that your child be excused from recitation of a portion of the Declaration of Independence. State law requires students in social studies classes in grades 3–12 to recite a portion of the text of the Declaration of Independence during Celebrate Freedom Week unless (1) you provide a written statement requesting that your child be excused, (2) the district determines that your child has a conscientious objection to the recitation, or (3) you are a representative of a foreign government to whom the United States government extends diplomatic immunity. [See policy EHBK(LEGAL). (www.centerisd.org)]

Requesting Limited or No Contact with a Student through Electronic Media

Teachers and other approved employees are permitted by the district to communicate with students through the use of electronic media within the scope of the individual's professional responsibilities. For example, a teacher may set up a social networking page for his or her class that has information related to class work, homework, and tests. As a parent, you are welcome to join or become a member of such a page.

An employee described above may also contact a student individually through electronic media to communicate about items such as homework or upcoming tests.

If you prefer that your child not receive any one-to-one electronic communications from a district employee, please submit a written request to the campus principal stating this preference.

Requesting Notices of Certain Student Misconduct

A noncustodial parent may request in writing that he or she be provided, for the remainder of the school year, a copy of any written notice usually provided to a parent related to his or her child's misconduct that may involve placement in a disciplinary alternative education program (DAEP) or expulsion. [See policy FO(LEGAL) (www.centerisd.org) and the Student Code of Conduct.]

School Safety Transfers

As a parent, you have a right:

- To request the transfer of your child to another classroom or campus if your child has been determined by the principal to have been a victim of bullying as the term is defined by Education Code 25.0341. [See policy FDB. (www.centerisd.org)]
[See **Bullying** on page 14, and policy FFI(LOCAL). (www.centerisd.org)]
- To request the transfer of your child to attend a safe public school in the district if your child attends school at a campus identified by TEA as persistently dangerous or if your child has been a victim of a violent criminal offense while at school or on school grounds. [See policy FDE(LOCAL). (www.centerisd.org)]
- To request the transfer of your child to another campus [or a neighboring district] if your child has been the victim of a sexual assault by another student assigned to the same campus, whether the assault occurred on or off campus, and that student has been convicted of or placed on deferred adjudication for that assault. [See policy FDE. (www.centerisd.org)]

Requesting Classroom Assignment for Multiple Birth Siblings

As a parent, if your children are multiple birth siblings (e.g., twins, triplets, etc.) assigned to the same grade and campus, you may request that they be placed either in the same classroom or in separate classrooms. Your written request must be submitted no later than the 14th day after the enrollment of your children. [See policy FDB(LEGAL). (www.centerisd.org)]

Parents of Students with Disabilities

If a student is receiving special education services at a campus outside his or her attendance zone, the parent or guardian may request that any other student residing in the household be transferred to the same campus, if the appropriate grade level for the transferring student is offered on that campus. [See policy FDB(LOCAL). (www.centerisd.org)]

Request for the Use of a Service Animal

A parent of a student who uses a service animal because of the student's disability must submit a request in writing to the principal at least ten district business days before bringing the service animal on campus.

Options and Requirements for Providing Assistance to Students Who Have Learning Difficulties or Who Need or May Need Special Education Services

If a child is experiencing learning difficulties, the parent may contact the person listed below to learn about the district's overall general education referral or screening system for support services. This system links students to a variety of support options, including referral for a special education evaluation. Students having difficulty in the regular classroom should be considered for tutorial, compensatory, and other academic or behavior support services that are available to all students including a process based on Response to Intervention (RtI). The implementation of Response to Intervention (RtI) has the potential to have a positive impact on the ability of school districts to meet the needs of all struggling students.

At any time, a parent is entitled to request an evaluation for special education services. Within a reasonable amount of time, the district must decide if the evaluation is needed. If the evaluation is needed, the parent will be notified and asked to provide informed written consent for the evaluation. The district must complete the evaluation and the report within 60 calendar days of the date the district receives the written consent. The district must give a copy of the report to the parent.

If the district determines that the evaluation is not needed, the district will provide the parent with prior written notice that explains why the child will not be evaluated. This written notice will include a statement that informs the parents of their rights if they parent disagree with the district. The district is required to give parents the *Notice of Procedural Safeguards—Rights of Parents of Students with Disabilities*. Additional information regarding the Individuals with Disabilities Education Act (IDEA) is available from the school district in a companion document, *A Guide to the Admission, Review, and Dismissal Process*.

The following Web sites provide information to those who are seeking information and resources specific to students with disabilities and their families:

- Texas Project First, at <http://www.texasprojectfirst.org/>
- Partners Resource Network, at <http://www.partnerstx.org/howPRNhelps.html>

The designated person to contact regarding options for a child experiencing learning difficulties or a referral for evaluation for special education services is Mickey Wulf at 598-1600.

Parents of Students who speak a Primary Language Other than English

A student may be eligible to receive specialized support if his or her primary language is not English, and the student has difficulty performing ordinary class work in English. If the student qualifies for these extra services, the Language Proficiency Assessment Committee (LPAC) will determine the types of services the student needs, including accommodations or modifications related to classroom instruction, local assessments, and state-mandated assessments.

Accommodations for Children of Military Families

Children of military families will be provided flexibility regarding certain district requirements, including:

- Immunization requirements.

- Grade level, course, or educational program placement.
- Eligibility requirements for participation in extracurricular activities.
- Graduation requirements.

In addition, absences related to a student visiting with his or her parent related to leave or deployment activities may be excused by the district.

Additional information may be found at <http://www.tea.state.tx.us/index2.aspx?id=7995>.

Student Records

Both federal and state laws safeguard student records from unauthorized inspection or use and provide parents and eligible students certain rights of privacy. Before disclosing any personally identifiable information from a student's records, the district must verify the identity of the person, including a parent or the student, requesting the information. For purposes of student records, an "eligible" student is one who is 18 or older OR who is attending an institution of postsecondary education.

Virtually all information pertaining to student performance, including grades, test results, and disciplinary records, is considered confidential educational records. Release is restricted to:

- The parents—whether married, separated, or divorced—unless the school is given a copy of a court order terminating parental rights or the right to access a student's education records.

Federal law requires that, as soon as a student becomes 18, is emancipated by a court, or enrolls in a postsecondary institution, control of the records goes to the student. The parents may continue to have access to the records, however, if the student is a dependent for tax purposes and under limited circumstances when there is a threat to the health and safety of the student or other individuals.

- District school officials who have what federal law refers to as a "legitimate educational interest" in a student's records. School officials would include trustees and employees, such as the superintendent, administrators, and principals; teachers, counselors, diagnosticians, and support staff; a person or company with whom the district has contracted or allowed to provide a particular service or function (such as an attorney, consultant, auditor, medical consultant, therapist, or volunteer); a parent or student serving on a school committee; or a parent or student assisting a school official in the performance of his or her duties. "Legitimate educational interest" in a student's records includes working with the student; considering disciplinary or academic actions, the student's case, or an individualized education program for a student with disabilities; compiling statistical data; reviewing an educational record to fulfill the official's professional responsibility; or investigating or evaluating programs.
- Various governmental agencies, including juvenile service providers.
- Individuals granted access in response to a subpoena or court order.
- A school or institution of postsecondary education to which a student seeks or intends to enroll or in which he or she is already enrolled.

Release to any other person or agency—such as a prospective employer or for a scholarship application—will occur only with parental or student permission as appropriate.

The principal is custodian of all records for currently enrolled students at the assigned school. The principal is the custodian of all records for students who have withdrawn or graduated.

Records may be inspected by a parent or eligible student during regular school hours. The records custodian or designee will respond to reasonable requests for explanation and interpretation of the records.

A parent or eligible student who provides a written request and pays copying costs of ten cents per page may obtain copies. If circumstances prevent inspection during regular school hours and the student qualifies for free or reduced-price meals, the district will either provide a copy of the records requested or make other arrangements for the parent or student to review these records. The address of the superintendent's office is P.O Box 1689/107 PR 605 Center, Texas 75935.

Contact your child's school office for the address of the principals' office.

A parent (or eligible student) may inspect the student's records and request a correction if the records are considered inaccurate, misleading, or otherwise in violation of the student's privacy rights. A request to correct a student's record should be submitted to the principal. The request must clearly identify the part of the record that should be corrected and include an explanation of how the information in the record is inaccurate. If the district denies the request to amend the records, the parent or eligible student has the right to request a hearing. If the records are not amended as a result of the hearing, the parent or eligible student has 30 school days to exercise the right to place a statement commenting on the information in the student's record. Although improperly recorded grades may be challenged, contesting a student's grade in a course is handled through the general complaint process found in policy FNG(LOCAL). A grade issued by a classroom teacher can be changed only if, as determined by the board of trustees, the grade is arbitrary, erroneous, or inconsistent with the district's grading policy. [See FINALITY OF GRADES at FNG(LEGAL), **Report Cards/Progress Reports and Conferences** on page 36, and **Student or Parent Complaints and Concerns** on page 15 for an overview of the process.]

The district's policy regarding student records found at FL(LEGAL) and (LOCAL) is available from the principal's or superintendent's office or on the district's Web site at www.centerisd.org.

The parent's or eligible student's right of access to and copies of student records do not extend to all records. Materials that are not considered educational records—such as a teacher's personal notes about a student that are shared only with a substitute teacher—do not have to be made available to the parents or student.

Please note:

Parents or eligible students have the right to file a complaint with the U.S. Department of Education if they believe the district is not in compliance with federal law regarding student records. The complaint may be mailed to:

Family Policy Compliance Office
U.S. Department of Education
400 Maryland Avenue, SW
Washington, DC 20202-5901

Directory Information

The law permits the district to designate certain personal information about students as “directory information.” This “directory information” will be released to anyone who follows procedures for requesting it.

However, release of a student’s directory information may be prevented by the parent or an eligible student if they fill out the denial form in the beginning of the year packet.

SECTION II: OTHER IMPORTANT INFORMATION FOR STUDENTS AND PARENTS

Topics in this section of the handbook contain important information on academics, school activities, and school operations and requirements. Take a moment with your child to become familiar with the various issues addressed in this section. It is organized in alphabetical order to serve as a quick-reference when you or your child has a question about a specific school-related issue. Should you be unable to find the information on a particular topic, please contact your child's school office.

ABSENCES/ATTENDANCE

Regular school attendance is essential for a student to make the most of his or her education—to benefit from teacher-led and school activities, to build each day's learning on the previous day's, and to grow as an individual. Absences from class may result in serious disruption of a student's mastery of the instructional materials; therefore, the student and parent should make every effort to avoid unnecessary absences. Two state laws—one dealing with compulsory attendance, the other with attendance for course credit—are of special interest to students and parents. They are discussed below.

Compulsory Attendance

State law requires that a student between the ages of six and 18 attend school, as well as any applicable accelerated instruction program, extended year program, or tutorial session, unless the student is otherwise excused from attendance or legally exempt.

A student who voluntarily attends or enrolls after his or her 18th birthday is required to attend each school day until the end of the school year and is subject to compulsory attendance laws, if the student is under 21 years old. In addition, if a student 18 or older has more than five unexcused absences in a semester the district may revoke the student's enrollment. The student's presence on school property thereafter would be unauthorized and may be considered trespassing. [See policy FEA. (www.centerisd.org)]

Students enrolled in prekindergarten or kindergarten are required to attend school.

State law requires attendance in an accelerated reading instruction program when kindergarten, first grade, or second grade students are assigned to such a program. Parents will be notified in writing if their child is assigned to an accelerated reading instruction program as a result of a diagnostic reading instrument.

A student in grades 3–8 will be required to attend any assigned accelerated instruction program, which may occur before or after school or during the summer, if the student does not meet the passing standards on the state assessment for his or her grade level and applicable subject area.

Exemptions to Compulsory Attendance

State law allows exemptions to the compulsory attendance requirements for several types of absences if the student makes up all work. These include the following activities and events:

- Religious holy days;
- Required court appearances;

- Activities related to obtaining United States citizenship;
- Service as an election clerk; and
- Documented health-care appointments, including absences for recognized services for students diagnosed with autism spectrum disorders. A note from the health-care provider must be submitted upon the student’s return to campus.

In addition, a junior or senior student’s absence of up to two days related to visiting a college or university will be considered an exemption, provided the student receives approval from the campus principal, follows the campus procedures to verify such a visit, and makes up any work missed.

Failure to Comply with Compulsory Attendance

School employees must investigate and report violations of the state compulsory attendance law. A student absent without permission from school; from any class; from required special programs, such as additional special instruction, termed “accelerated instruction” by the state; or from required tutorials will be considered in violation of the compulsory attendance law and subject to disciplinary action.

A court of law may also impose penalties against both the student and his or her parents if a school-aged student is deliberately not attending school. A complaint against the parent may be filed in court if the student:

- Is absent from school on ten or more days or parts of days within a six-month period in the same school year, or
- Is absent on three or more days or parts of days within a four-week period.

For a student younger than 12 years of age, the student’s parent could be charged with a criminal offense based on the student’s failure to attend school.

If a student between the ages of 12 and 18 violates the compulsory attendance law, both the parent and student could be charged with a criminal offense.

If the student is age 18 or older, the [student](#), but not the student’s parents, [would](#) be subject to penalties as a result of the [student’s](#) violation of state compulsory attendance law. [See policy FEA(LEGAL). (www.centerisd.org)]

Attendance for Credit

To receive credit in a class, a student must attend at least 90 percent of the days the class is offered. A student who attends at least 75 percent but fewer than 90 percent of the days the class is offered may receive credit for the class if he or she completes a plan, approved by the principal, that allows the student to fulfill the instructional requirements for the class. If a student is involved in a criminal or juvenile court proceeding, the approval of the judge presiding over the case will also be required before the student receives credit for the class.

If a student attends less than 75 percent of the days a class is offered or has not completed a plan approved by the principal, then the student will be referred to the attendance review committee to determine whether there are extenuating circumstances for the absences and how the student can regain credit, if appropriate. [See policies at FEC. (www.centerisd.org)]

In determining whether there were extenuating circumstances for the absences, the attendance committee will use the following guidelines:

- All absences will be considered in determining whether a student has attended the required percentage of days. If makeup work is completed, absences for the reasons listed above at **Exemptions to Compulsory Attendance** will be considered days of attendance for this purpose.
- A transfer or migrant student begins to accumulate absences only after he or she has enrolled in the district.
- In reaching a decision about a student's absences, the committee will attempt to ensure that it is in the best interest of the student.
- The committee will consider the acceptability and authenticity of documented reasons for the student's absences.
- The committee will consider whether the absences were for reasons over which the student or the student's parent could exercise any control.
- The committee will consider the extent to which the student has completed all assignments, mastered the essential knowledge and skills, and maintained passing grades in the course or subject.
- The student or parent will be given an opportunity to present any information to the committee about the absences and to talk about ways to earn or regain credit.

The student or parent may appeal the committee's decision to the board of trustees by filing a written request with the superintendent in accordance with policy FNG(LOCAL).

The actual number of days a student must be in attendance in order to receive credit will depend on whether the class is for a full semester or for a full year.

Parent's Note after an Absence

When a student must be absent from school, the student—upon returning to school—must bring a note signed by the parent that describes the reason for the absence within three school days. A note signed by the student, even with the parent's permission, will not be accepted unless the student is 18 or older.

Doctor's Note after an Absence for Illness

Upon return to school, a student absent for more than three consecutive days because of a personal illness must bring a statement from a doctor or health clinic verifying the illness or condition that caused the student's extended absence from school.

Should the student develop a questionable pattern of absences, the principal or attendance committee may require a statement from a doctor or health clinic verifying the illness or condition that caused the student's absence from school.

[See policy FEC(LOCAL). (www.centerisd.org)]

BULLYING

Bullying occurs when a student or group of students **engages in** written or verbal expression or physical conduct against another student and the behavior:

- results in harm to the student or the student's property,
- places a student in fear of physical harm or of damage to the student's property, or
- is so severe, persistent, or pervasive that it creates an intimidating, threatening, or abusive educational environment.

Bullying is prohibited by the district and could include hazing, threats, taunting, teasing, assault, demands for money, confinement, destruction of property, theft of valued possessions, name-calling, rumor-spreading, and ostracism. In some cases, bullying can occur through electronic methods, called "cyberbullying."

If a student believes that he or she has experienced bullying or has witnessed bullying of another student, it is important for the student or parent to notify a teacher, counselor, principal, or another district employee as soon as possible. The administration will investigate any allegations of bullying and will take appropriate disciplinary action if an investigation indicates that bullying has occurred. Disciplinary or other action may be taken even if the conduct did not rise to the level of bullying. Any retaliation against a student who reports an incident of bullying is prohibited.

[Also see policy FFI(LOCAL)].

CHILD SEXUAL ABUSE AND OTHER MALTREATMENT OF CHILDREN

The district has established a plan for addressing child sexual abuse and other maltreatment of children, which may be found in the District Improvement Plan. As a parent, it is important for you to be aware of warning signs that could indicate a child may have been or is being sexually abused. Sexual abuse in the Texas Family Code is defined as any sexual conduct harmful to a child's mental, emotional, or physical welfare as well as a failure to make a reasonable effort to prevent sexual conduct with a child. Anyone who suspects that a child has been or may be abused or neglected has a legal responsibility, under state law, for reporting the suspected abuse or neglect to law enforcement or to Child Protective Services (CPS).

Possible physical warning signs of sexual abuse could be difficulty sitting or walking, pain in the genital areas, and claims of stomachaches and headaches. Behavioral indicators may include verbal references or pretend games of sexual activity between adults and children, fear of being alone with adults of a particular gender, or sexually suggestive behavior. Emotional warning signs to be aware of include withdrawal, depression, sleeping and eating disorders, and problems in school.

A child who has experienced sexual abuse or any other type of abuse or neglect should be encouraged to seek out a trusted adult. Be aware as a parent or other trusted adult that disclosures of sexual abuse and neglect, may be more indirect than disclosures of physical abuse, and it is important to be calm and comforting if your child, or another child, confides in you. Reassure the child that he or she did the right thing by telling you.

As a parent, if your child is a victim of sexual abuse, the campus counselor or principal will provide information regarding counseling options for you and your child available in your area. The Texas Department of Family and Protective Services (TDFPS) also manages early intervention counseling programs. To find out what services may be available in your county, see

[http://www.dfps.state.tx.us/Prevention and Early Intervention/Programs Available In Your County/default.asp](http://www.dfps.state.tx.us/Prevention%20and%20Early%20Intervention/Programs%20Available%20In%20Your%20County/default.asp).

The following Web sites might help you become more aware of child sexual abuse:

<http://www.childwelfare.gov/pubs/factsheets/signs.cfm>

<http://sapn.nonprofitoffice.com/>

<http://www.taasa.org/member/materials2.php>

http://www.oag.state.tx.us/AG_Publications/txts/childabuse1.shtml

http://www.oag.state.tx.us/AG_Publications/txts/childabuse2.shtml

Reports may be made to:

The Child Protective Services (CPS) division of the Texas Department of Family and Protective Services (1-800-252-5400 or on the Web at <http://www.txabusehotline.org>).

[For further information, see policies at EIC.]

CLASS SCHEDULES

All students are expected to attend school for the entire school day and maintain a class/course schedule to fulfill each period of the day. Exceptions may be made occasionally by the campus principal for students in grades 9–12 who meet specific criteria and receive parental consent to enroll in less than a full-day’s schedule.

CLASS OFFERED

CENTER INTERMEDIATE

- | | |
|-------------------|----------------------------------|
| 1. Math | 6 Fine Arts |
| 2. Reading | 7. Computer Lab |
| 3. ELA | 8. Math and Reading Acceleration |
| 4. Social Studies | 9. Physical Education |
| 5. Science | |

COMPLAINTS AND CONCERNS

Usually student or parent complaints or concerns can be addressed by a phone call or a conference with the teacher or principal. For those complaints and concerns that cannot be handled so easily, the district has adopted a standard complaint policy at FNG(LOCAL) in the district’s policy manual. A copy of this policy may be obtained in the principal’s or superintendent’s office or on the district’s Web site at www.centerisd.org.

In general, the student or parent should submit a written complaint and request a conference with the campus principal. If the concern is not resolved, a request for a conference should be sent to

the superintendent. If still unresolved, the district provides for the complaint to be presented to the board of trustees.

CONDUCT

Applicability of School Rules

As required by law, the board has adopted a Student Code of Conduct that prohibits certain behaviors and defines standards of acceptable behavior—both on and off campus—and consequences for violation of these standards. The district has disciplinary authority over a student in accordance with the Student Code of Conduct. Students and parents should be familiar with the standards set out in the Student Code of Conduct, as well as campus and classroom rules.

Corporal Punishment

Corporal punishment—spanking or paddling the student—may be used as a discipline management technique in accordance with the Student Code of Conduct and policy FO(LOCAL). See appendix IV

Disruptions of School Operations

Disruptions of school operations are not tolerated and may constitute a misdemeanor offense. As identified by law, disruptions include the following:

- Interference with the movement of people at an exit, entrance, or hallway of a district building without authorization from an administrator.
- Interference with an authorized activity by seizing control of all or part of a building.
- Use of force, violence, or threats in an attempt to prevent participation in an authorized assembly.
- Use of force, violence, or threats to cause disruption during an assembly.
- Interference with the movement of people at an exit or an entrance to district property.
- Use of force, violence, or threats in an attempt to prevent people from entering or leaving district property without authorization from an administrator.
- Disruption of classes or other school activities while on district property or on public property that is within 500 feet of district property. Class disruption includes making loud noises; trying to entice a student away from, or to prevent a student from attending, a required class or activity; and entering a classroom without authorization and disrupting the activity with loud or profane language or any misconduct.
- Interference with the transportation of students in vehicles owned or operated by the district.

Social Events

School rules apply to all school social events. Guests attending these events are expected to observe the same rules as students, and a student inviting a guest will share responsibility for the conduct of his or her guest.

A student attending a social event will be asked to sign out when leaving before the end of the event; anyone leaving before the official end of the event will not be readmitted.

CONFERENCES

Parents and teachers are encouraged to establish and maintain frequent communication about student progress.

A student or parent who wants information or wants to raise a question or concern is encouraged to talk with the appropriate teacher, counselor, or principal. A parent who wants to meet with a teacher may call the office for an appointment during the teacher's conference period or may request that the teacher call the parent during a conference period or at another mutually convenient time.

Students and parents may expect teachers to request a conference (1) if the student is not maintaining passing grades or achieving the expected level of performance, (2) if the student presents any other problem to the teacher, or (3) in any other case the teacher considers necessary.

CONTAGIOUS DISEASES / CONDITIONS

To protect other students from contagious illnesses, students infected with certain diseases are not allowed to come to school while contagious. If a parent suspects that his or her child has a contagious disease, the parent should contact the school nurse or principal so that other students who might have been exposed to the disease can be alerted.

The school nurse or the principal's office can provide information from the Department of State Health Services regarding these diseases.

COUNSELING

Personal Counseling

The school counselor is available to assist students with a wide range of personal concerns, including such areas as social, family, or emotional issues, or substance abuse. The counselor may also make available information about community resources to address these concerns. A student who wishes to meet with the counselor should contact your school counselor or school office.

Psychological Exams, Tests, or Treatment

The school will not conduct a psychological examination, test, or treatment without first obtaining the parent's written consent. Parental consent is not necessary when a psychological examination, test, or treatment is required by state or federal law for special education purposes or by the Texas Education Agency for child abuse investigations and reports.

[For more information, refer to policies EHBAA(LEGAL), FFE(LEGAL), and FFG(EXHIBIT). (www.centerisd.org)]

CREDIT BY EXAM—If a Student Has Taken the Course

A student who has previously taken a course or subject—but did not receive credit for it—may, in circumstances determined by the principal or attendance committee, be permitted to earn credit by passing an exam on the essential knowledge and skills defined for that course or subject. Prior instruction may include, for example, incomplete coursework due to a failed

course or excessive absences, homeschooling, or coursework by a student transferring from a nonaccredited school.

The counselor or principal would determine if the student could take an exam for this purpose. If approval is granted, the student must score at least 70 on the exam to receive credit for the course or subject.

The attendance review committee may also offer a student with excessive absences an opportunity to earn credit for a course by passing an exam.

[For further information, see the counselor and policy EHDB(LOCAL). (www.centerisd.org)]

CREDIT BY EXAM—If a Student Has Not Taken the Course

A student will be permitted to take an exam to earn credit for an academic course for which the student has had no prior instruction or to accelerate to the next grade level. Contact your school office for dates on which exams are scheduled during the 2011–2012 school year.

A student will earn course credit with a passing score of at least 90 on the exam. A student in elementary school will be eligible to accelerate to the next grade level if the student scores at least 90 on each exam in the subject areas of language arts, mathematics, science, and social studies.

[For further information, see policy EHDC(LOCAL.) (www.centerisd.org)

DISCRIMINATION, HARASSMENT, AND RETALIATION

The district believes that all students learn best in an environment free from dating violence, discrimination, harassment, and retaliation and that their welfare is best served when they are free from this prohibited conduct while attending school. Students are expected to treat other students and district employees with courtesy and respect, to avoid behaviors known to be offensive, and to stop those behaviors when asked or told to stop. District employees are expected to treat students with courtesy and respect.

The board has established policies and procedures to prohibit and promptly respond to inappropriate and offensive behaviors that are based on a person's race, color, religion, gender, national origin, disability, or any other basis prohibited by law. [See policy FFH.]

Discrimination

Discrimination is defined as any conduct directed at a student on the basis of race, color, religion, gender, national origin, disability, or any other basis prohibited by law, that negatively affects the student.

Harassment

Harassment, in general terms, is conduct so severe, persistent, or pervasive that it affects the student's ability to participate in or benefit from an educational program or activity; creates an intimidating, threatening, hostile, or offensive educational environment; or substantially interferes with the student's academic performance. A copy of the district's policy is available in the principal's office and in the superintendent's office or at the district web site.

Examples of harassment may include, but are not limited to, offensive or derogatory language directed at a person's religious beliefs or practices, accent, skin color, or need for

accommodation; threatening or intimidating conduct; offensive jokes, name-calling, slurs, or rumors; physical aggression or assault; graffiti or printed material promoting racial, ethnic, or other negative stereotypes; or other kinds of aggressive conduct such as theft or damage to property.

Sexual Harassment

Sexual harassment of a student by an employee, volunteer, or another student is prohibited.

Sexual harassment of a student by an employee or volunteer does not include necessary or permissible physical contact not reasonably construed as sexual in nature. However, romantic and other inappropriate social relationships, as well as all sexual relationships, between students and district employees are prohibited, even if consensual.

Examples of prohibited sexual harassment may include, but not be limited to, touching private body parts or coercing physical contact that is sexual in nature; sexual advances; jokes or conversations of a sexual nature; and other sexually motivated conduct, communications, or contact.

Retaliation

Retaliation against a person who makes a good faith report of discrimination or harassment, including dating violence, is prohibited. Retaliation against a person who is participating in an investigation of alleged discrimination or harassment is also prohibited. A person who makes a false claim or offers false statements or refuses to cooperate with a district investigation, however, may be subject to appropriate discipline.

Retaliation against a student might occur when a student receives threats from another student or an employee or when an employee imposes an unjustified punishment or unwarranted grade reduction. Retaliation does not include petty slights and annoyances from other students or negative comments from a teacher that are justified by a student's poor academic performance in the classroom.

Reporting Procedures

Any student who believes that he or she has experienced dating violence, discrimination, harassment, or retaliation should immediately report the problem to a teacher, counselor, principal, or other district employee. The report may be made by the student's parent. See policy FFH(LOCAL) (www.centerisd.org) for the appropriate district officials to whom to make a report.

Investigation of Report

To the extent possible, the district will respect the privacy of the student; however, limited disclosures may be necessary to conduct a thorough investigation and to comply with law. Allegations of prohibited conduct, which includes dating violence, discrimination, harassment, and retaliation, will be promptly investigated. The district will notify the parents of any student alleged to have experienced prohibited conduct involving an adult associated with the district.

In the event prohibited conduct involves another student, the district will notify the parents of the student alleged to have experienced the prohibited conduct when the allegations, if proven, would constitute a violation as defined by policy.

If the district's investigation indicates that prohibited conduct occurred, appropriate disciplinary or corrective action will be taken to address the conduct. The district may take disciplinary action even if the conduct that is the subject of the complaint was not unlawful.

A student or parent who is dissatisfied with the outcome of the investigation may appeal in accordance with policy FNG(LOCAL). (www.centerisd.org)

DISTRIBUTION OF PUBLISHED MATERIALS OR DOCUMENTS

School Materials

Publications prepared by and for the school may be posted or distributed, with the prior approval of the principal, sponsor, or teacher. Such items may include school posters, brochures, flyers, etc.

All school publications are under the supervision of a teacher, sponsor, and the principal.

Nonschool Materials...from students

Students must obtain prior approval from the principal before posting, circulating, or distributing more than ten copies of written materials, handbills, photographs, pictures, petitions, films, tapes, posters, or other visual or auditory materials that were not developed under the oversight of the school. To be considered, any nonschool material must include the name of the sponsoring person or organization. The decision regarding approval will be made within two school days. [See policies at FNAA.]

A student may appeal a principal's decision in accordance with policy FNG(LOCAL) (www.centerisd.org). Any student who posts nonschool material without prior approval will be subject to disciplinary action in accordance with the Student Code of Conduct. Materials displayed without the principal's approval will be removed.

Nonschool Materials...from others

Written or printed materials, handbills, photographs, pictures, films, tapes, or other visual or auditory materials not sponsored by the district or by a district-affiliated school-support organization will not be sold, circulated, distributed, or posted on any district premises by any district employee or by persons or groups not associated with the district, except as permitted by policy GKDA. To be considered for distribution, any nonschool material must meet the limitations on content established in the policy, include the name of the sponsoring person or organization, and be submitted to the principal for prior review. The principal will approve or reject the materials within two school days of the time the materials are received. The requestor may appeal a rejection in accordance with the appropriate district complaint policy. [See policies at DGBA, FNG, or GF.]

Prior review will not be required for:

- Distribution of materials by an attendee to other attendees of a school-sponsored meeting intended for adults and held after school hours.
- Distribution of materials by an attendee to other attendees of a community group meeting held after school hours in accordance with policy GKD(LOCAL) or a noncurriculum-related student group meeting held in accordance with FNAB(LOCAL) (www.centerisd.org).

- Distribution for electioneering purposes during the time a school facility is being used as a polling place, in accordance with state law.

All nonschool materials distributed under these circumstances must be removed from district property immediately following the event at which the materials are distributed.

DRESS AND GROOMING

The District's dress code is established to teach grooming and hygiene, instill discipline, prevent disruption, avoid safety hazards, and teach respect for authority.

Students shall be dressed and groomed in a manner that is clean and neat and that will not be a health or safety hazard to themselves or others. The District prohibits any clothing or grooming that in the principal's judgment may be reasonably expected to cause disruption of or interference with normal school operations.

The District prohibits pictures, emblems, or writings on clothing that:

1. Are lewd, offensive, vulgar, or obscene
2. Advertise or depict tobacco products, alcoholic beverages, drugs, or any other substance prohibited under FNCF (Local Board Policy)

The Dress Code for Pre-K to fifth grade include:

1. Loose fitting shorts can be worn by both girls and boys (No more than 2 inches above the knee)
2. No jeans having slits or holes
3. No bicycle racing pants
4. No tank tops for girls or boys
5. No midriff, see through, mesh or halter tops for girls or boys
6. Dresses or skirts shall be no more than 2 inches above the knee
7. Any apparel that advertises or implies sex, drugs, alcohol, profanity or violence is not permitted
8. Clothing that represents clubs, gangs, or groups other than those sponsored by the school are is not permitted
9. Wearing caps, hats or hoods are not permitted on school campus (exception-special activities allow)
10. The Administration has the right to ask students to change their dress if it causes a distraction or disruption of the school
11. Pants with belt loops are required to have a belt.
12. No Heelies. (shoes that have wheels underneath the shoes sole that make the shoes roll)

If the principal determines that a student's grooming or clothing violates the school's dress code, the student will be given an opportunity to correct the problem at school. If not corrected, the student will be assigned to in-school suspension for the remainder of the day, until the problem is corrected, or until a parent or designee brings an acceptable change of clothing to the school. Repeated offenses may result in more serious disciplinary action in accordance with the Student Code of Conduct.

ELECTRONIC DEVICES AND TECHNOLOGY RESOURCES

Possession and Use of Personal Telecommunications Devices, Including Mobile Telephones

For safety purposes, the district permits students to possess personal mobile telephones; however, these devices must remain turned off during the instructional day, including during all testing, unless they are being used for approved instructional purposes. A student must have approval to possess other telecommunications devices such as netbooks, laptops, tablets, or other portable computers.

The use of mobile telephones or any device capable of capturing images is strictly prohibited in locker rooms or restroom areas while at school or at a school-related or school-sponsored event.

If a student uses a telecommunications device without authorization during the school day, the device will be confiscated. See below for consequences per campus.

Confiscated telecommunications devices that are not retrieved by the student or the student's parents will be disposed of after the notice required by law. [See policy FNCE.]

In limited circumstances and in accordance with law, a student's personal telecommunications device may be searched by authorized personnel. [See policy FNF.]

Any disciplinary action will be in accordance with the Student Code of Conduct. The district will not be responsible for damaged, lost, or stolen telecommunications devices.

Possession and Use of Other Personal Electronic Devices

Except as described below, students are not permitted to possess, **use or turn on** personal electronic devices such as MP3 players, video or audio recorders, DVD players, cameras, games, e-readers, or other electronic devices at school, unless prior permission has been obtained **by the** campus principal. Without such permission, teachers will collect the items and turn them in to the principal's office. The principal will determine whether to return items to students at the end of the day or to contact parents to pick up the items.

In limited circumstances and in accordance with law, a student's personal electronic device may be searched by authorized personnel. [See **Searches** on page 37 and policy FNF.]

Any disciplinary action will be in accordance with the Student Code of Conduct. The district will not be responsible for any damaged, lost, or stolen electronic device.

Instructional Use of Personal Telecommunications and Other Electronic Devices

In some cases, students may find it beneficial or might be encouraged to use personal telecommunications or other personal electronic devices for instructional purposes while on campus. Students must obtain prior approval before using personal telecommunications or other personal electronic devices for instructional use. Students must also sign a user agreement that contains applicable rules for use (separate from this handbook). When students are not using the devices for approved instructional purposes, all devices must be turned off during the instructional day. Violations of the user agreement may result in withdrawal of privileges and other disciplinary action.

All electronic devices are discouraged to be brought to school. If a student is found in possession of an electronic device the following consequences will occur:

Center Intermediate

Consequences

1st time taken up- Parent picks up from the office

2nd time-\$10 fee-parent picks up from the office

3rd time-Not returned until the end of the year

F.L. Moffett and Center Elementary

Consequences

1st time-Warning to student and parent is contacted

2nd time-Item taken up and parent pick up item at the office

3rd - time-Taken up and fee of \$10 will be charged to the parent

Acceptable Use of District Technology Resources

To prepare students for an increasingly technological society, the district has made an investment in the use of district-owned technology resources for instructional purposes; specific resources may be issued individually to students. Use of these technological resources, which include the district's network systems and use of district equipment, is restricted to approved purposes only. Students and parents will be asked to sign a user agreement (separate from this handbook) regarding use of these district resources. Violations of the user agreement may result in withdrawal of privileges and other disciplinary action.

Unacceptable and Inappropriate Use of Technology Resources

Students are prohibited from possessing, sending, forwarding, posting, accessing, or displaying electronic messages that are abusive, obscene, sexually oriented, threatening, harassing, damaging to another's reputation, or illegal. This prohibition applies to conduct off school property, whether the equipment used to send such messages is district-owned or personally owned, if it results in a substantial disruption to the educational environment. Any person taking, disseminating, transferring, possessing or sharing obscene, sexually oriented, lewd, or otherwise illegal images or other content, commonly referred to as "sexting," will be disciplined according to the Student Code of Conduct and may, in certain circumstances, be reported to law enforcement.

In addition, any student who engages in conduct that results in a breach of the district's computer security will be disciplined in accordance with the Student Code of Conduct, and, in some cases, the consequence may rise to the level of expulsion.

EMERGENCY SCHOOL CLOSING INFORMATION

Emergency school closing information will be broadcast on local radio stations, KDET--930 AM and 100.5 FM.

EXTRACURRICULAR ACTIVITIES, CLUBS, AND ORGANIZATIONS

Standards of Behavior

Sponsors of student clubs and performing groups such as the band, choir, and drill and athletic teams may establish standards of behavior—including consequences for misbehavior—that are stricter than those for students in general. If a violation is also a violation of school rules, the consequences specified by the Student Code of Conduct or by local policy will apply in addition to any consequences specified by the organization’s standards of behavior.

Eligibility for initial and continuing participation in many of these activities is governed by state law and the rules of the University Interscholastic League (UIL)—a statewide association overseeing interdistrict competition. If a student is involved in an academic, athletic, or music activity governed by UIL, the student and parent are expected to know and follow all rules of the UIL organization. [See <http://www.uil texas.org> for additional information.]

The following requirements apply to all extracurricular activities:

- A student who receives at the end of a grading period a grade below 70 in any academic class—other than an Advanced Placement or International Baccalaureate course; or an honors or dual credit course in English language arts, mathematics, science, social studies, economics, or language other than English—may not participate in extracurricular activities for at least three school weeks.
- A student with disabilities who fails to meet the standards in the individualized education program (IEP) may not participate for at least three school weeks.
- An ineligible student may practice or rehearse.
- A student is allowed in a school year up to _____ absences not related to post-district competition, a maximum of _____ absences for post-district competition prior to state, and a maximum of _____ absences for state competition. All extracurricular activities and public performances, whether UIL activities or other activities approved by the board, are subject to these restrictions.
- An absence for participation in an activity that has not been approved will receive an unexcused absence.

[For further information, see policies at FM and FO.]

FEES

Materials that are part of the basic educational program are provided with state and local funds at no charge to a student. A student, however, is expected to provide his or her own pencils, paper, erasers, and notebooks and may be required to pay certain other fees or deposits, including:

- Costs for materials for a class project that the student will keep.
- Membership dues in voluntary clubs or student organizations and admission fees to extracurricular activities.
- Security deposits.
- Personal physical education and athletic equipment and apparel.

- Voluntarily purchased pictures, publications, class rings, yearbooks, graduation announcements, etc.
- Voluntarily purchased student accident insurance.
- Musical instrument rental and uniform maintenance, when uniforms are provided by the district.
- Personal apparel used in extracurricular activities that becomes the property of the student.
- Parking fees and student identification cards.
- Fees for lost, damaged, or overdue library books.
- Fees for driver training courses, if offered.
- Fees for optional courses offered for credit that require use of facilities not available on district premises.
- Summer school for courses that are offered tuition-free during the regular school year.

FIELD TRIPS

Field trips are taken by students. Any student wishing to accompany his/her teacher on a class outing must bring a written permission from his/her parents or guardian to school. Notices will be sent home prior to any trip. These must be signed and returned. No student will be allowed to attend a field trip without proper notice of parental permission.

FUND-RAISING

Student groups or classes and/or parent groups may be permitted to conduct fund-raising drives for approved school purposes.

GANG-FREE ZONES

Certain criminal offenses, including those involving organized criminal activity such as gang-related crimes, will be enhanced to the next highest category of offense if they are committed in a gang-free zone. For purposes of the district, a gang-free zone includes a school bus and a location in, on, or within 1,000 feet of any district-owned or leased property or campus playground.

GIFTED AND TALENTED (SEE ADDENDUM I)

The Elementary GT program is designed to involve students in enriching, multifaceted curriculum during the school day. The instructional focus is on the development of independent research skills, creative problem solving, and logical, critical, and divergent thinking strategies. The students are cluster grouped within GT certified classrooms in grades 1-3. Students are given opportunities to work with GT certified teachers and peers through the following activities, strategies, and opportunities.

Activities, Strategies, and Opportunities

- Independent Studies
- Advanced Curriculum
- Advanced Reading

- Research Projects
- Leadership Projects
- Extended Curriculum
- Science and Art Centers
- Special Reports
- Group Projects
- Credit by Exam
- Region VII Service Center Opportunities

Center ISD offers a K-12 program for gifted learner which focuses on general intellectual ability. The program addresses each of the four core subject areas (math, language arts, science and social studies). Activities and teaching strategies are designed to develop creative thinking, problem solving and decision making skills in participating students.

If you have any question please contact the school counselor.

GRADING GUIDELINES

Grading guidelines see campus principal for more information or a copy of campus grading guidelines. See Addendum VI

GRADES ON-LINE

To access your student’s report card and 3-week progress report on –line, go to the Center ISD website www.centerisd.org. You will need your their student ID and Social Security number.

GUIDANCE AND COUNSELING SERVICES

Guidance and counseling service shall be designed primarily to provide ongoing assistance to enhance the educational development of all students.

The services may assist individuals or groups of students in:

1. Improving academic achievement.
2. Improving school attendance.
3. Improving school attitudes.
4. Developing self-confidence.
5. Developing healthy interpersonal relationships.
6. Developing life satisfaction.
7. Obtaining information to assist in choosing a potential career.

HARASSMENT

[See STUDENT WELFARE FFH
FREEDOM FROM HARASSMENT (LOCAL)
FFH(LOCAL)-A] (www.centerisd.org)

HAZING

Hazing is defined as any intentional, knowing, or reckless act occurring on or off campus directed against a student that endangers the mental or physical health or the safety of a student for the purpose of pledging, being initiated to, affiliating with, holding office in, or maintaining membership in any organization whose members are or include other students.

Hazing will not be tolerated by the district. If an incident of hazing occurs, disciplinary consequences will be handled in accordance with the Student Code of Conduct. It is a criminal offense if a person engages in hazing; solicits, encourages, directs, aids, or attempts to aid another in hazing; or has firsthand knowledge of an incident of hazing being planned or having occurred and fails to report this to the principal or superintendent.

[Also see **Bullying** on page 14 and policies FFI and FNCC.] (www.centerisd.org)

HEALTH-RELATED MATTERS

Bacterial Meningitis

State law specifically requires the district to provide the following information:

- What is meningitis?

Meningitis is an inflammation of the covering of the brain and spinal cord. It can be caused by viruses, parasites, fungi, and bacteria. Viral meningitis is most common and the least serious. Bacterial meningitis is the most common form of serious bacterial infection with the potential for serious, long-term complications. It is an uncommon disease, but requires urgent treatment with antibiotics to prevent permanent damage or death.

- What are the symptoms?

Someone with meningitis will become very ill. The illness may develop over one or two days, but it can also rapidly progress in a matter of hours. Not everyone with meningitis will have the same symptoms.

Children (over 1 year old) and adults with meningitis may have a severe headache, high temperature, vomiting, sensitivity to bright lights, neck stiffness or joint pains, and drowsiness or confusion. In both children and adults, there may be a rash of tiny, red-purple spots. These can occur anywhere on the body.

The diagnosis of bacterial meningitis is based on a combination of symptoms and laboratory results.

- How serious is bacterial meningitis?

If it is diagnosed early and treated promptly, the majority of people make a complete recovery. In some cases it can be fatal or a person may be left with a permanent disability.

- How is bacterial meningitis spread?

Fortunately, none of the bacteria that cause meningitis are as contagious as diseases like the common cold or the flu, and they are not spread by casual contact or by simply breathing the air where a person with meningitis has been. The germs live naturally in the back of our noses and throats, but they do not live for long outside the body. They are spread when

people exchange saliva (such as by kissing, sharing drinking containers, utensils, or cigarettes).

The germ does not cause meningitis in most people. Instead, most people become carriers of the germ for days, weeks, or even months. The bacteria rarely overcome the body's immune system and cause meningitis or another serious illness.

- How can bacterial meningitis be prevented?

Do not share food, drinks, utensils, toothbrushes, or cigarettes. Limit the number of persons you kiss.

While there are vaccines for some other strains of bacterial meningitis, they are used only in special circumstances. These include when there is a disease outbreak in a community or for people traveling to a country where there is a high risk of getting the disease. Also, a vaccine is recommended by some groups for college students, particularly freshmen living in dorms or residence halls. The vaccine is safe and effective (85–90 percent). It can cause mild side effects, such as redness and pain at the injection site lasting up to two days. Immunity develops within seven to ten days after the vaccine is given and lasts for up to five years.

- What should you do if you think you or a friend might have bacterial meningitis?

You should seek prompt medical attention.

- Where can you get more information?

Your school nurse, family doctor, and the staff at your local or regional health department office are excellent sources for information on all communicable diseases. You may also call your local health department or Regional Department of State Health Services office to ask about a meningococcal vaccine. Additional information may also be found at the Web sites for the Centers for Disease Control and Prevention, <http://www.cdc.gov>, and the Department of State Health Services, <http://www.dshs.state.tx.us/>.

Food Allergies

The district requests to be notified when a student has been diagnosed with a food allergy, especially those allergies that could result in dangerous or possibly life-threatening reactions either by inhalation, ingestion, or skin contact with the particular food. It is important to disclose the food to which the student is allergic, as well as the nature of the allergic reaction. Please contact the school nurse or campus principal if your child has a known food allergy or as soon as possible after any diagnosis of a food allergy.

Physical Activity for Students in Elementary and Middle School

In accordance with policies at EHAB, EHAC, EHBG, and FFA, the district will ensure that students in full-day prekindergarten through grade 5 engage in moderate or vigorous physical activity for at least 30 minutes per day or 135 minutes per week.

For additional information on the district's requirements and programs regarding elementary, middle, and junior high school student physical activity requirements, please see the principal.

School Health Advisory Council (SHAC)

During the preceding school year, the district's School Health Advisory Council held 4 meetings. Additional information regarding the district's School Health Advisory Council is available from the Angela Lawson at 598-7291. [See also policies at BDF and EHAA.] (www.centerisd.org)

The duties of the SHAC range from recommending curriculum to developing strategies for integrating curriculum into a coordinated school health program encompassing school health services, counseling services, a safe and healthy school environment, recess recommendations, and employee wellness. See policies at BDF and EHAA. (www.centerisd.org)

Other Health-Related Matters

Physical Fitness Assessment

Annually, the district will conduct a physical fitness assessment of students in grades 3–12 who are enrolled in a physical education course or a course for which physical education credit is awarded. At the end of the school year, a parent may submit a written request to your child's campus office to obtain the results of his or her child's physical fitness assessment conducted during the school year.

Vending Machines

The district has adopted policies and implemented procedures to comply with state and federal food service guidelines for restricting student access to vending machines. For more information regarding these policies and guidelines see campus office. [See policies at CO and FFA.]

Tobacco Prohibited

The district and its staff strictly enforce prohibitions against the use of tobacco products by students and others on school property and at school-sponsored and school-related activities. [See the Student Code of Conduct and policies at FNCD and GKA.]

Asbestos Management Plan

The district works diligently to maintain compliance with federal and state law governing asbestos in school buildings. A copy of the district's Asbestos Management Plan is available in the superintendent's office. If you have any questions or would like to examine the district's plan in more detail, please contact the district's designated asbestos coordinator; at 598-8366.

Pest Management Plan

The district is required to follow integrated pest management (IPM) procedures to control pests on school grounds. Although the district strives to use the safest and most effective methods to manage pests, including a variety of non-chemical control measures, pesticide use is sometimes necessary to maintain adequate pest control and ensure a safe, pest-free school environment.

All pesticides used are registered for their intended use by the United States Environmental Protection Agency and are applied only by certified pesticide applicators. Except in an emergency, signs will be posted 48 hours before indoor application. All outdoor applications will be posted at the time of treatment, and signs will remain until it is safe to enter the area. Parents who have further questions or who want to be notified prior to pesticide application inside their child's school assignment area may contact the district's IPM coordinator; at 598-8366.

HOMELESS STUDENTS

For more information on services for homeless students, contact the district's Liaison for Homeless Children and Youths, at 598-7291.

HOMEWORK

Homework is an integral part of the learning process to support, enrich, and reinforce topics covered in class. Homework shall be purposeful and shall satisfy at least one of the following objectives:

1. To provide a drill that helps the student practice the basic skills of a subject.
2. To give students practice and extension of concepts learned in class.
3. To extend learning beyond the material that can be covered in class.
4. To develop effective study methods.
5. To develop responsible work habits.
6. To assist in communicating to parents what their child is learning and how the child is doing in assigned work at school.
7. To help the student prepare for classroom work.

The student's responsibility shall be to complete assignments on time. Parents are responsible for ensuring that their child does the homework assigned each day. Regular monitoring of homework provides a good overview of how and what the student is doing in various subjects. Homework provides a regular channel of communication between the parent and the teacher.

IMMUNIZATION

A student must be fully immunized against certain diseases or must present a certificate or statement that, for medical reasons or reasons of conscience, including a religious belief, the student will not be immunized. For exemptions based on reasons of conscience, only official forms issued by the Texas Department of State Health Services (DSHS), Immunization Branch, can be honored by the district. This form may be obtained by writing the DSHS Immunization Branch (MC 1946), P.O. Box 149347, Austin, Texas 78714-9347; or online at <https://webds.dshs.state.tx.us/immco/affidavit.shtm>. The form must be notarized and submitted to the principal or school nurse within 90 days of notarization. If the parent is seeking an exemption for more than one student in the family, a separate form must be provided for each student.

The immunizations required are: diphtheria, rubeola (measles), rubella (German measles), mumps, tetanus, pertussis, poliomyelitis (polio), hepatitis A, hepatitis B, varicella (chicken pox), and meningococcal. The school nurse can provide information on age-appropriate doses or on an acceptable physician-validated history of illness required by the Department of State Health Services. Proof of immunization may be established by personal records from a licensed physician or public health clinic with a signature or rubber-stamp validation.

If a student should not be immunized for medical reasons, the student or parent must present a certificate signed by a U.S. licensed physician stating that, in the doctor's opinion, the immunization required poses a significant risk to the health and well-being of the student or a member of the student's family or household. This certificate must be renewed yearly unless the physician specifies a life-long condition. [For further information, see policy FFAB(LEGAL)

and the Department of State Health Services Web site:
<http://www.dshs.state.tx.us/immunize/school/default.shtm.>]

LAW ENFORCEMENT AGENCIES

Questioning of Students

When law enforcement officers or other lawful authorities wish to question or interview a student at school, the principal will cooperate fully regarding the conditions of the interview, if the questioning or interview is part of a child abuse investigation. In other circumstances:

- The principal will verify and record the identity of the officer or other authority and ask for an explanation of the need to question or interview the student at school.
- The principal ordinarily will make reasonable efforts to notify the parents unless the interviewer raises what the principal considers to be a valid objection.
- The principal ordinarily will be present unless the interviewer raises what the principal considers to be a valid objection.

Students Taken Into Custody

State law requires the district to permit a student to be taken into legal custody:

- To comply with an order of the juvenile court.
- To comply with the laws of arrest.
- By a law enforcement officer if there is probable cause to believe the student has engaged in delinquent conduct or conduct in need of supervision.
- By a probation officer if there is probable cause to believe the student has violated a condition of probation imposed by the juvenile court.
- By an authorized representative of Child Protective Services, Texas Department of Family and Protective Services, a law enforcement officer, or a juvenile probation officer, without a court order, under the conditions set out in the Family Code relating to the student's physical health or safety.
- To comply with a properly issued directive to take a student into custody.

Before a student is released to a law enforcement officer or other legally authorized person, the principal will verify the officer's identity and, to the best of his or her ability, will verify the official's authority to take custody of the student.

The principal will immediately notify the superintendent and will ordinarily attempt to notify the parent unless the officer or other authorized person raises what the principal considers to be a valid objection to notifying the parents. Because the principal does not have the authority to prevent or delay a student's release to a law enforcement officer, any notification will most likely be after the fact.

Notification of Law Violations

The district is required by state law to notify:

- All instructional and support personnel who have responsibility for supervising a student who has been arrested or referred to the juvenile court for any felony offense or for certain misdemeanors.
- All instructional and support personnel who have regular contact with a student who is required to register as a sex offender or who has been convicted, received deferred prosecution, received deferred adjudication, or was adjudicated for delinquent conduct for any felony offense or certain misdemeanors.

[For further information, see policies FL(LEGAL) and GRA(LEGAL).]

LIMITED ENGLISH PROFICIENT STUDENTS

A student with limited English proficiency (LEP) is entitled to receive specialized services from the district. To determine whether the student qualifies for services, a Language Proficiency Assessment Committee (LPAC) will be formed, which will consist of both district personnel and at least one parent representative. The student's parent must consent to any services recommended by the LPAC for a LEP student.

In order to determine a student's level of proficiency in English, the LPAC will use information from a variety of assessments. If the student qualifies for services and once a level of proficiency has been established, the LPAC will then designate instructional accommodations or additional special programs the student will require to eventually become proficient at grade level work in English. Ongoing assessments will be conducted to determine a student's continued eligibility for the program.

The LPAC will also determine whether certain accommodations are necessary for any state-mandated assessments. The STAAR-L, as mentioned at Standardized Testing, below, may be administered to a LEP student. The Texas English Language Proficiency Assessment System (TELPAS) will also be administered to LEP students who qualify for services.

If a student is considered LEP and receives special education services because of a qualifying disability, the student's ARD committee will make these decisions.

MAKEUP WORK

Makeup Work Because of Absence

For any class missed, the teacher may assign the student makeup work based on the instructional objectives for the subject or course and the needs of the individual student in mastering the essential knowledge and skills or in meeting subject or course requirements.

A student will be responsible for obtaining and completing the makeup work in a satisfactory manner and within the time specified by the teacher. [For further information, see policy EIAB(LOCAL).] (www.centerisd.org)

A student who does not make up assigned work within the time allotted by the teacher will receive a grade of zero for the assignment.

A student will be permitted to make up tests and to turn in projects due in any class missed because of absence. Teachers may assign a late penalty to any long-term project in accordance with time lines approved by the principal and previously communicated to students.

In-school Suspension (ISS) Makeup Work

A student removed from the regular classroom to in-school suspension or another setting, other than a DAEP, will have an opportunity to complete before the beginning of the next school year each course the student was enrolled in at the time of removal from the regular classroom. The district may provide the opportunity by any method available, including a correspondence course, another distance learning option, or summer school. The district will not charge the student for any method of completion provided by the district. [See policy FO(LEGAL).]

MEDICINE AT SCHOOL

District employees will not give a student prescription medication, nonprescription medication, herbal substances, anabolic steroids, or dietary supplements, with the following exceptions:

- Only authorized employees, in accordance with policies at FFAC, may administer:
 - Prescription medication, in the original, properly labeled container, provided by the parent, along with a written request.
 - Prescription medication from a properly labeled unit dosage container filled by a registered nurse or another qualified district employee from the original, properly labeled container.
 - Nonprescription medication, in the original, properly labeled container, provided by the parent along with a written request.
 - Herbal or dietary supplements provided by the parent only if required by the student's individualized education program (IEP) or Section 504 plan for a student with disabilities.
- In certain emergency situations, the district will maintain and administer to a student nonprescription medication, but only:
 - In accordance with the guidelines developed with the district's medical advisor; and
 - When the parent has previously provided written consent to emergency treatment on the district's form.

A student with asthma or severe allergic reaction (anaphylaxis) may be permitted to possess and use prescribed asthma or anaphylaxis medication at school or school-related events only if he or she has written authorization from his or her parent and a physician or other licensed health-care provider. The student must also demonstrate to his or her physician or health-care provider and to the school nurse the ability to use the prescribed medication, including any device required to administer the medication.

If the student has been prescribed asthma or anaphylaxis medication for use during the school day, the student and parents should discuss this with the school nurse or principal.

In accordance with a student's individual health plan for management of diabetes, a student with diabetes will be permitted to possess and use monitoring and treatment supplies and equipment while at school or at a school-related activity. See the school nurse or principal for information. [See policy FFAF(LEGAL). (www.centerisd.org)]

NONDISCRIMINATION STATEMENT

In its efforts to promote nondiscrimination, Center I.S.D. does not discriminate on the basis of race, religion, color, national origin, gender, or disability in providing education services, activities, and programs, including CTE programs, in accordance with Title VI of the Civil Rights Act of 1964, as amended; Title IX of the Educational Amendments of 1972; and Title II of the Americans with Disabilities Act of 1990 (ADA), as amended, which incorporates and expands upon the requirements of Section 504 of the Rehabilitation Act of 1973, as amended.

The following district representatives have been designated to coordinate compliance with these legal requirements:

Title IX Coordinator, for concerns regarding discrimination on the basis of gender:

Dr. James Hockenberry, Superintendent

107 PR 605

Center, TX 75935

(936) 598-5642

ADA/Section 504 Coordinator, for concerns regarding discrimination on the basis of disability:

Mickey Wulf, Director of Special Services

107 PR 605

Center, TX 75935

(936) 598-1600

- All other concerns regarding discrimination: See the superintendent [See policies FB(LOCAL) and FFH(LOCAL). (www.centerisd.org)]

PLEDGES OF ALLEGIANCE AND A MINUTE OF SILENCE

Each school day, students will recite the Pledge of Allegiance to the United States flag and the Pledge of Allegiance to the Texas flag. Parents may submit a written request to the principal to excuse their child from reciting a pledge.

One minute of silence will follow recitation of the pledges. Each student may choose to reflect, pray, meditate, or engage in any other silent activity during that minute so long as the silent activity does not interfere with or distract others. [See policy EC(LEGAL) for more information.]

PRAYER

Each student has a right to individually, voluntarily, and silently pray or meditate in school in a manner that does not disrupt instructional or other activities of the school. The school will not encourage, require, or coerce a student to engage in or to refrain from such prayer or meditation during any school activity.

PROMOTION AND RETENTION

A student will be promoted only on the basis of academic achievement or demonstrated proficiency in the subject matter of the course or grade level, the recommendation of the student's teacher, the score received on any criterion-referenced or state-mandated assessment, and any other necessary academic information as determined by the district. To earn credit in a course, a student must receive a grade of at least 70 based on course-level or grade-level standards.

In grades 1-5 promotion is based on [refer to your EIE(LOCAL) [at the district web site at www.centerisd.org](http://www.centerisd.org)].

In addition, at certain grade levels a student—with limited exceptions—will be required to pass the State of Texas Assessments of Academic Readiness (STAAR), if the student is enrolled in a public Texas school on any day between January 1 and the date of the first administration of the STAAR.*

- In order to be promoted to grade 6, students enrolled in grade 5 must perform satisfactorily on the mathematics and reading sections of the grade 5 assessment in English or Spanish.
- In order to be promoted to grade 9, students enrolled in grade 8 must perform satisfactorily on the mathematics and reading sections of the grade 8 assessment in English.

* Because the 2011–2012 school year is the first year of implementation of the STAAR, students will not be required by state law to perform satisfactorily on the grade 5 or 8 STAARs for this one year only in order to be promoted to the next grade level.

If a student in grade 5 or 8 is enrolled in a course that earns high school credit and for which an end-of-course (EOC) assessment will be administered or in a course intended for students above the student's current grade level in which the student will be administered a state mandated assessment, the student will not be subject to the promotion requirements described above for the relevant grade 5 or 8 assessment. However, the student's score on the EOC assessment will be used in determining whether the student meets the minimum cumulative score required for graduation.

If a student is enrolled in a class or course intended for students above his or her current grade level in which the student will be administered a state mandated assessment, the student will only be required to take an applicable state mandated assessment for the course in which he or she is enrolled.

Parents of a student in grades 3–8 who does not perform satisfactorily on his or her exams will be notified that their child will participate in special instructional programs designed to improve performance. The student may be required to participate in this instruction before or after normal school hours or outside of the normal school year.

With the exception of the 2011–2012 school year, a student in grade 5 or 8 will have two additional opportunities to take a failed assessment. If a student fails a second time, a grade placement committee, consisting of the principal or designee, the teacher, and the student's parent, will determine the additional special instruction the student will receive. After a third failed attempt, the student will be retained; however, the parent can appeal this decision to the committee. In order for the student to be promoted, based on standards previously established by the district, the decision of the committee must be unanimous and the student must complete

additional special instruction before beginning the next grade level. Whether the student is retained or promoted, an educational plan for the student will be designed to enable the student to perform at grade level by the end of the next school year. [See policies at EIE.]

Certain students—some with disabilities and some with limited English proficiency—may be eligible for exemptions, accommodations, or deferred testing. For more information, see the principal, counselor, or special education director.

A Personal Graduation Plan (PGP) will be prepared for any student in a middle school or beyond who did not perform satisfactorily on a state-mandated assessment or is determined by the district as not likely to earn a high school diploma before the fifth school year following enrollment in grade 9. The PGP will be designed and implemented by a guidance counselor, teacher, or other staff member designated by the principal. The plan will, among other items, identify the student's educational goals, address the parent's educational expectations for the student, and outline an intensive instruction program for the student. [For additional information, see the counselor or principal and policy EIF(LEGAL).] For a student receiving special education services, the student's IEP may serve as the student's PGP and would therefore be developed by the student's ARD committee.

RELEASE OF STUDENTS FROM SCHOOL

Because class time is important, doctor's appointments should be scheduled, if possible, at times when the student will not miss instructional time.

A student who will need to leave school during the day must bring a note from his or her parent that morning and follow the campus sign-out procedures before leaving the campus. Otherwise, a student will not be released from school at times other than at the end of the school day. Unless the principal or superintendent has granted approval because of extenuating circumstances, a student will not regularly be released before the end of the instructional day.

If a student becomes ill during the school day, the student should receive permission from the teacher before reporting to the school nurse. The nurse will decide whether or not the student should be sent home and will notify the student's parent.

REPORT CARDS / PROGRESS REPORTS AND CONFERENCES

Report cards with each student's grades or performance and absences in each class or subject are issued to parents at least once every six weeks.

At the end of the first three weeks of a grading period parents will be given a written progress report if their child's performance is near or below 70, or is below the expected level of performance. If the student receives a grade lower than 70 in any class or subject at the end of a grading period, the parent will be requested to schedule a conference with the teacher of that class or subject.

Teachers follow grading guidelines that have been approved by the principal pursuant to the board-adopted policy and are designed to reflect each student's relative mastery of each assignment for the grading period, semester, or course. State law provides that a test or course grade issued by a teacher cannot be changed unless the board determines that the grade was arbitrary or contains an error, or that the teacher did not follow the district's grading policy.

Questions about grade calculation should first be discussed with the teacher; if the question is not resolved, the student or parent may request a conference with the principal in accordance with FNG(LOCAL) (www.centerisd.org).

The report card or unsatisfactory progress report will state whether tutorials are required for a student who receives a grade lower than 70 in a class or subject.

SAFETY

Student safety on campus and at school-related events is a high priority of the district. Although the district has implemented safety procedures, the cooperation of students is essential to ensuring school safety. A student should:

- Avoid conduct that is likely to put the student or others at risk.
- Follow the behavioral standards in this handbook and the Student Code of Conduct, as well as any additional rules for behavior and safety set by the principal, teachers, or bus drivers.
- Remain alert to and promptly report to a teacher or the principal any safety hazards, such as intruders on campus or threats made by any person toward a student or staff member.
- Know emergency evacuation routes and signals.
- Follow immediately the instructions of teachers, bus drivers, and other district employees who are overseeing the welfare of students.

Accident Insurance

Soon after the school year begins, parents will have the opportunity to purchase low-cost accident insurance that would help meet medical expenses in the event of injury to their child.

Drills: Fire, Tornado, and Other Emergencies

From time to time, students, teachers, and other district employees will participate in drills of emergency procedures. When the alarm is sounded, students should follow the direction of teachers or others in charge quickly, quietly, and in an orderly manner.

Emergency Medical Treatment and Information

If a student has a medical emergency at school or a school-related activity when the parent cannot be reached, the school may have to rely on written parental consent to obtain emergency medical treatment, and information about allergies to medications, foods, insect bites, etc. Therefore, parents are asked each year to complete an emergency care consent form. Parents should keep emergency care information up-to-date (name of doctor, emergency phone numbers, allergies, etc.). Please contact the school nurse to update any information that the nurse or the teacher needs to know.

Emergency School-Closing Information

Each year, parents are asked to complete an emergency release form to provide contact information in the event that school is dismissed early because of severe weather or another emergency.

SCHOOL HOURS:

F.L. Moffett Primary

- The School day is 7:45 – 2:55
- The first bell will ring at 7:50
- The tardy bell will ring at 7:55

Center Elementary

- The school day is 7:45 – 3:00
- The first bell will ring at 7:45-Students need to be in the gym for morning assembly.
- The tardy bell will ring at 7:50

Center Intermediate

- The school day is 7:45 – 3:15
- The first bell will ring at 7:45-Students need to be in the gym for morning assembly.
- The tardy bell will ring at 7:55

SCHOOL FACILITIES

Conduct Before and After School

Teachers and administrators have full authority over student conduct at before- or after-school activities on district premises and at school-sponsored events off district premises, such as play rehearsals, club meetings, athletic practices, and special study groups or tutorials. Students are subject to the same rules of conduct that apply during the instructional day and will be subject to consequences established by the Student Code of Conduct or any stricter standards of behavior established by the sponsor for extracurricular participants.

Use of Hallways During Class Time

Loitering or standing in the halls during class is not permitted. During class time, a student must have a hall pass to be outside the classroom for any purpose. Failure to obtain a pass will result in disciplinary action in accordance with the Student Code of Conduct.

Cafeteria Services

The district participates in the School Breakfast Program and National School Lunch Program and offers students nutritionally balanced meals daily. Free and reduced-price meals are available based on financial need. Information about a student's participation is confidential. See your school office to apply.

The district follows the federal and state guidelines regarding foods of minimal nutritional value being served or sold on school premises during the school day. [For more information, see policy CO(LEGAL). (www.centerisd.org)]

Library

The library is a learning laboratory with books, computers, magazines, and other materials available for classroom assignments, projects, and reading or listening pleasure.

Meetings of Noncurriculum-Related Groups

Student-organized, student-led noncurriculum-related groups are permitted to meet during the hours designated by the principal before and after school. These groups must comply with the requirements of policy FNAB(LOCAL).

A list of these groups is available in the principal's office.

SEARCHES

In the interest of promoting student safety and attempting to ensure that schools are safe and drug free, district officials may from time to time conduct searches. Such searches are conducted without a warrant and as permitted by law.

Students' Desks and Lockers

Students' desks and lockers are school property and remain under the control and jurisdiction of the school even when assigned to an individual student.

Students are fully responsible for the security and contents of their assigned desks and lockers. Students must be certain that their lockers are locked, and that the combinations are not available to others.

Searches of desks or lockers may be conducted at any time there is reasonable cause to believe that they contain articles or materials prohibited by policy, whether or not a student is present.

The parent will be notified if any prohibited items are found in the student's desk or locker.

Electronic Devices

Use of district-owned equipment and its network systems is not private and will be monitored by the district. [See policy CQ for more information. (www.centerisd.org)]

Any searches of personal telecommunications or other personal electronic devices will be conducted in accordance with law, and the device may be confiscated in order to perform a lawful search. A confiscated device may be turned over to law enforcement to determine whether a crime has been committed.

[See policy FNF(LEGAL) for more information. (www.centerisd.org)]

SPECIAL PROGRAMS

The district provides special programs for gifted and talented students, homeless students, bilingual students, migrant students, students with limited English proficiency, dyslexic students, and students with disabilities. The coordinator of each program can answer questions about eligibility requirements, as well as programs and services offered in the district or by other organizations. A student or parent with questions about these programs should [contact Special Education](#) director at 598-2700.

STANDARDIZED TESTING

Students in certain grade do take the ITBS: Iowa Tests of Basic Skills. The purposes of this testing are to estimate the general developmental level of each student, identify areas of relative strength and weakness for use in planning for early intervention, establish a baseline of

achievement information, and provide a basis for reports to parents. The IOWA test is just one of several tools utilized to evaluate a student's academic development and progress.

STAAR (State of Texas Assessments of Academic Readiness)

Grades 3–8

In addition to routine tests and other measures of achievement, students at certain grade levels will take state-mandated assessments, such as the STAAR, in the following subjects:

- Mathematics, annually in grades 3–8
- Reading, annually in grades 3–8
- Writing, including spelling and grammar, in grades 4 and 7
- Science in grades 5 and 8
- Social Studies in grade 8

Successful performance on the reading and math assessments in grades 5 and 8 is required by law in order for the student to be promoted to the next grade level. For the 2011–2012 school year only, this requirement will be waived. See **Promotion and Retention** on page 33 for additional information.

STAAR Modified and STAAR Alternate, for students receiving special education services, will be available for eligible students, as determined by the student's ARD committee.

STAAR-L is a linguistically accommodated assessment that is available for certain limited English proficient (LEP) students, as determined by the student's Language Proficiency Assessment Committee (LPAC).

STAAR Modified and STAAR Alternate, for students receiving special education services, will be available for eligible students, as determined by the student's ARD committee. These particular EOC assessments may have different testing windows than the general assessments, and the ARD committee will determine whether successful performance on the assessments will be required for graduation.

STAAR-L, which is a linguistically accommodated assessment, will be available for students who have been determined to be limited English proficient (LEP) and who require this type of testing accommodation.

Additional information will be provided to students and parents prior to the spring 2012 administrations.

STUDENTS IN PROTECTIVE CUSTODY OF THE STATE

The district strives to assist any student who has been placed in either temporary or permanent conservatorship (custody) of the state of Texas with the enrollment and registration process, as well as other educational services throughout the student's enrollment in the district. For more information please contact Special Education Director at 598-1600.

SUICIDE AWARENESS

The district is committed to partnering with parents to support the healthy mental, emotional, and behavioral development of its students. If you are concerned about your child, please access the following Web sites or contact the school counselor for more information related to suicide prevention and to find mental health services available in your area:

- www.texasuicideprevention.org
- <http://www.dshs.state.tx.us/mhservices-search/>

TARDINESS

Parents are encouraged to have their student on time to school each day. Classroom instruction starts immediately after the tardy bell rings. Tardy bell rings at different times at each campus. (See page 36)

TEXTBOOKS, ELECTRONIC TEXTBOOKS, AND TECHNOLOGICAL EQUIPMENT

State-approved textbooks are provided to students free of charge for each subject or class. Books must be covered by the student, as directed by the teacher, and treated with care. Electronic textbooks and technological equipment may also be provided to students, depending on the course and course objectives. A student who is issued a damaged item should report the damage to the teacher. Any student failing to return an item in acceptable condition loses the right to free textbooks and technological equipment until the item is returned or paid for by the parent; however, the student will be provided textbooks and equipment for use at school during the school day.

TRANSFERS

The Center I. S. D. attendance policy will apply to all students who transfer from a school in Texas. All transfers must submit required forms by May 1st. Status is granted for the following year. The number of absences the student has accrued at the time of entry will be applied to local policy. (Board Policy FDA)

Students entering the District from non-accredited public, private or parochial schools may be initially placed at the discretion of the principal pending observation by the classroom teacher, guidance personnel, and a principal. (Board Policy FD) Criteria for initial or final placement may include:

1. Scores on achievement tests, which may be administered by District personnel
2. Recommendation of the sending school
3. Prior academic record
4. Chronological age and social and emotional development of the student
5. Other criteria as deemed appropriate by the principal

TRANSPORTATION

School-Sponsored Trips

Students who participate in school-sponsored trips are required to use transportation provided by the school to and from the event. The principal, however, may make an exception if the parent makes a written request that the student be released to the parent or to another adult designated by the parent.

Buses and Other School Vehicles

The district makes school bus transportation available to all students living two or more miles from school. This service is provided at no cost to students. Bus routes and any subsequent changes are posted at the school and on the district's web site at www.centerisd.org.

A parent may also designate a child-care facility or grandparent's residence as the regular pickup and drop-off location for his or her child. The designated facility or residence must be on an approved stop on an approved route. For information on bus routes and stops or to designate an alternate pickup or drop-off location, you may contact transportation department at 598-2880.

See the Student Code of Conduct for provisions regarding transportation to the DAEP.

Students are expected to assist district staff in ensuring that buses remain in good condition and that transportation is provided safely. When riding in district vehicles, students are held to behavioral standards established in this handbook and the Student Code of Conduct. Students must:

- Follow the driver's directions at all times.
- Enter and leave the bus or van in an orderly manner at the designated stop.
- Keep feet, books, instrument cases, and other objects out of the aisle.
- Not deface the bus, van, or its equipment.
- Not put head, hands, arms, or legs out of the window, hold any object out of the window, or throw objects within or out of the bus or van.
- Not possess or use any form of tobacco on school buses.
- Observe all usual classroom rules.
- Be seated while the vehicle is moving.
- Fasten their seat belts, if available.
- Wait for the driver's signal upon leaving the bus or van and before crossing in front of the vehicle.

Misconduct will be punished in accordance with the Student Code of Conduct; bus-riding privileges may be suspended.

UIL

UIL (2nd grade to 5th grade) is academic competition with students from other districts. More detailed information will be made available to parents at the proper time.

VANDALISM

The taxpayers of the community have made a sustained financial commitment for the construction and upkeep of school facilities. To ensure that school facilities can serve those for whom they are intended—both this year and for years to come—littering, defacing, or damaging school property is not tolerated. Students will be required to pay for damages they cause and will be subject to criminal proceedings as well as disciplinary consequences in accordance with the Student Code of Conduct.

VIDEO CAMERAS

For safety purposes, video/audio equipment may be used to monitor student behavior, including on buses and in common areas on campus. Students will not be told when the equipment is being used.

The principal will review the video/audio recordings routinely and document student misconduct. Discipline will be in accordance with the Student Code of Conduct.

VISITORS TO THE SCHOOL

General Visitors

Parents and others are welcome to visit district schools. For the safety of those within the school and to avoid disruption of instructional time, **all visitors must first report to the principal's office and must comply with all applicable district policies and procedures.**

Visits to individual classrooms during instructional time are permitted only with approval of the principal and teacher and only so long as their duration or frequency does not interfere with the delivery of instruction or disrupt the normal school environment.

All visitors are expected to demonstrate the highest standards of courtesy and conduct; disruptive behavior will not be permitted.

WITHDRAWING FROM SCHOOL

A student under 18 may be withdrawn from school only by a parent. The school requests notice from the parent at least three days in advance so that records and documents may be prepared. The parent may obtain a withdrawal form from the principal's office.

On the student's last day, the withdrawal form must be presented to each teacher for current grade averages and book and equipment clearance; to the librarian to ensure a clear library record; to the clinic for health records; to the counselor for the last report card and course clearance; and finally, to the principal. A copy of the withdrawal form will be given to the student, and a copy will be placed in the student's permanent record.

A student who is 18 or older, who is married, or who has been declared by a court to be an emancipated minor may withdraw without parental signature.

Glossary

Accelerated instruction is an intensive supplemental program designed to address the needs of an individual student in acquiring the knowledge and skills required at his or her grade level and/or as a result of a student not meeting the passing standard on a state-mandated assessment.

ACT refers to one of the two most frequently used college or university admissions exams: the American College Test. The test may be a requirement for admission to certain colleges or universities.

ARD is the admission, review, and dismissal committee convened for each student who is identified as needing a full and individual evaluation for special education services. The eligible student and his or her parents are members of the committee.

Attendance review committee is sometimes responsible for reviewing a student's absences when the student's attendance drops below 90 percent of the days the class is offered. Under guidelines adopted by the board, the committee will determine whether there were extenuating circumstances for the absences and whether the student needs to complete certain conditions to master the course and regain credit lost because of absences.

DAEP stands for disciplinary alternative education program, a placement for students who have violated certain provisions of the Student Code of Conduct.

EOC assessments are end-of-course tests, which are state-mandated, and are part of the STAAR program. Successful performance on EOC assessments will be required for graduation beginning with students in grade 9 during the 2011–2012 school year. These exams will be given in English I, English II, English III, Algebra I, Geometry, Algebra II, Biology, Chemistry, Physics, World Geography, World History, and United States History.

FERPA refers to the federal Family Educational Rights and Privacy Act that grants specific privacy protections to student records. The law contains certain exceptions, such as for directory information, unless a student's parent or a student 18 or older directs the school not to release directory information.

IEP is the written record of the individualized education program prepared by the ARD committee for a student with disabilities who is eligible for special education services. The IEP contains several parts, such as a statement of the student's present educational performance; a statement of measurable annual goals, with short-term objectives; the special education and related services and supplemental aids and services to be provided, and program modifications or support by school personnel; a statement regarding how the student's progress will be measured and how the parents will be kept informed; accommodations for state or districtwide tests; whether successful completion of state-mandated assessments is required for graduation, etc.

ISS refers to in-school suspension, a disciplinary technique for misconduct found in the Student Code of Conduct. Although different from out-of-school suspension and placement in a DAEP, ISS removes the student from the regular classroom.

LAT stands for linguistically accommodated testing, which is an assessment process for recent immigrant English language learners who are required to be assessed in certain grades and subjects under the NCLB Act.

NCLB Act is the federal No Child Left Behind Act of 2001.

PGP stands for Personal Graduation Plan , which is recommended for all students entering grade 9 and is required by state law for any student in middle school or higher who fails a section on a state-mandated test or is identified by the district as not likely to earn a high school diploma before the fifth school year after he or she begins grade 9.

SAT refers to one of the two most frequently used college or university admissions exams: the Scholastic Aptitude Test. The test may be a requirement for admissions to certain colleges or universities.

SHAC stands for School Health Advisory Council, a group of at least five members, a majority of whom must be parents, appointed by the school board to assist the district in ensuring that local community values and health issues are reflected in the district's health education instruction.

Section 504 is the federal law that prohibits discrimination against a student with a disability, requiring schools to provide opportunities for equal services, programs, and participation in activities. Unless the student is determined to be eligible for special education services under the Individuals with Disabilities Education Act (IDEA), general education with appropriate instructional accommodations will be provided.

STAAR is the State of Texas Assessments of Academic Readiness, the state's system of standardized academic achievement assessments, effective beginning with certain students for the 2011–2012 school year.

STAAR Alternate is an alternative state-mandated assessment designed for students with severe cognitive disabilities receiving special education services who meet the participation requirements, as determined by the student's ARD committee.

STAAR Modified is an alternative state-mandated assessment based on modified achievement standards that is administered to eligible students receiving special education services, as determined by the student's ARD committee.

STAAR Linguistically Accommodated (STAAR L) is an alternative state-mandated assessment with linguistic accommodations designed for certain recent immigrant English language learners.

State-mandated assessments are required of students at certain grade levels and in specified subjects. Successful performance sometimes is a condition of promotion, and passing the grade 11 exit-level test or end-of-course assessments, when applicable, is a condition of graduation. Students have multiple opportunities to take the tests if necessary for promotion or graduation.

Student Code of Conduct is developed with the advice of the district-level committee and adopted by the board and identifies the circumstances, consistent with law, when a student may be removed from the classroom or campus. It also sets out the conditions that authorize or require the principal or another administrator to place the student in a DAEP. It outlines conditions for out-of-school suspension and for expulsion. The Student Code of Conduct also addresses notice to the parent regarding a student's violation of one of its provisions.

TAKS is the Texas Assessment of Knowledge and Skills, the state's standardized achievement test currently given to students in certain subjects in grades 10 and 11 and is required for graduation for students at these grade levels. .

TELPAS stands for the Texas English Language Proficiency Assessment System, which assesses the progress that English language learners make in learning the English language, and is administered for those who meet the participation requirements in kindergarten–grade 12.

TxVSN is the Texas Virtual School Network, which provides online courses for Texas students to supplement the instructional programs of public school districts. Courses are taught by qualified instructors, and courses are equivalent in rigor and scope to a course taught in a traditional classroom setting.

UIL refers to the University Interscholastic League, the statewide voluntary nonprofit organization that oversees educational extracurricular academic, athletic, and music contests.

APPENDIX I

CENTER ISD GIFTED AND TALENTED PROGRAM

IDENTIFICATION PROCESS

Steps in the Identification Process

Nominations may be made by one of the following: (All nominations for the current year must be submitted by the end of the nomination window that is in the fall.)

Nominations from the student, parent or other relatives, community members or classroom teacher or other professional staff member

Survey of Scores on TAKS and/or norm referenced test

Screening

Screening will be conducted after nomination window ends.

A matrix will be completed for each student screened. The matrix will consist of scores from each of the identification assessments required.

Students transferring from an existing gifted program in another school district may be screened during the first six weeks after enrollment according to the transfer policy.

Selection

Students are admitted to the G/T program on recommendation of the G/T Review Committee.

Student matrix scores will be considered by the G/T Review Committee for possible placement or non-placement of students.

A student recommended for placement in the G/T program must have written consent of his/her parent or guardian on file before being admitted to the program.

Recommendations of the G/T Review Committee may be appealed according to the district appeals policy.

Responsibilities of the G/T Review Committee

The G/T Review Committee shall consist of:

Administrator

Counselor

Gifted Program Teacher

Two regular classroom teachers

Each referred student's matrix will be reviewed in a formal meeting of the committee to consider placement.

Each matrix must be signed by a majority of the review committee members after determining that all criteria for appropriate placement have been reviewed and complied with.

Students are admitted to the G/T program on recommendation of the G/T Review Committee.

APPENDIX II

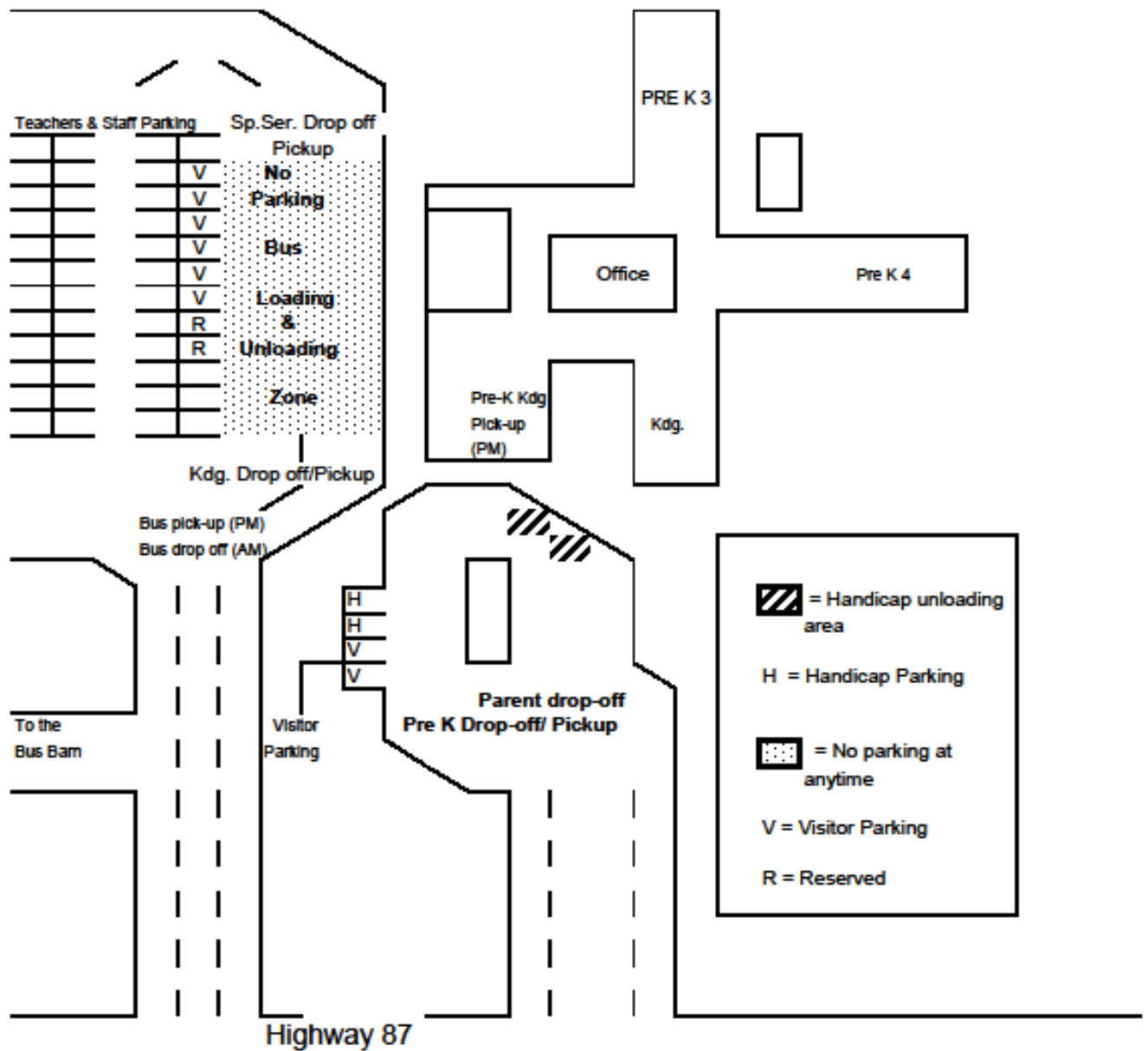

Center Elementary School

Roughrider drive

Parent drop off-AM

Parent Pick-up –PM all grades

Visitor parking

Bus drop off-AM
Bus drop off-PM
Staff parking only

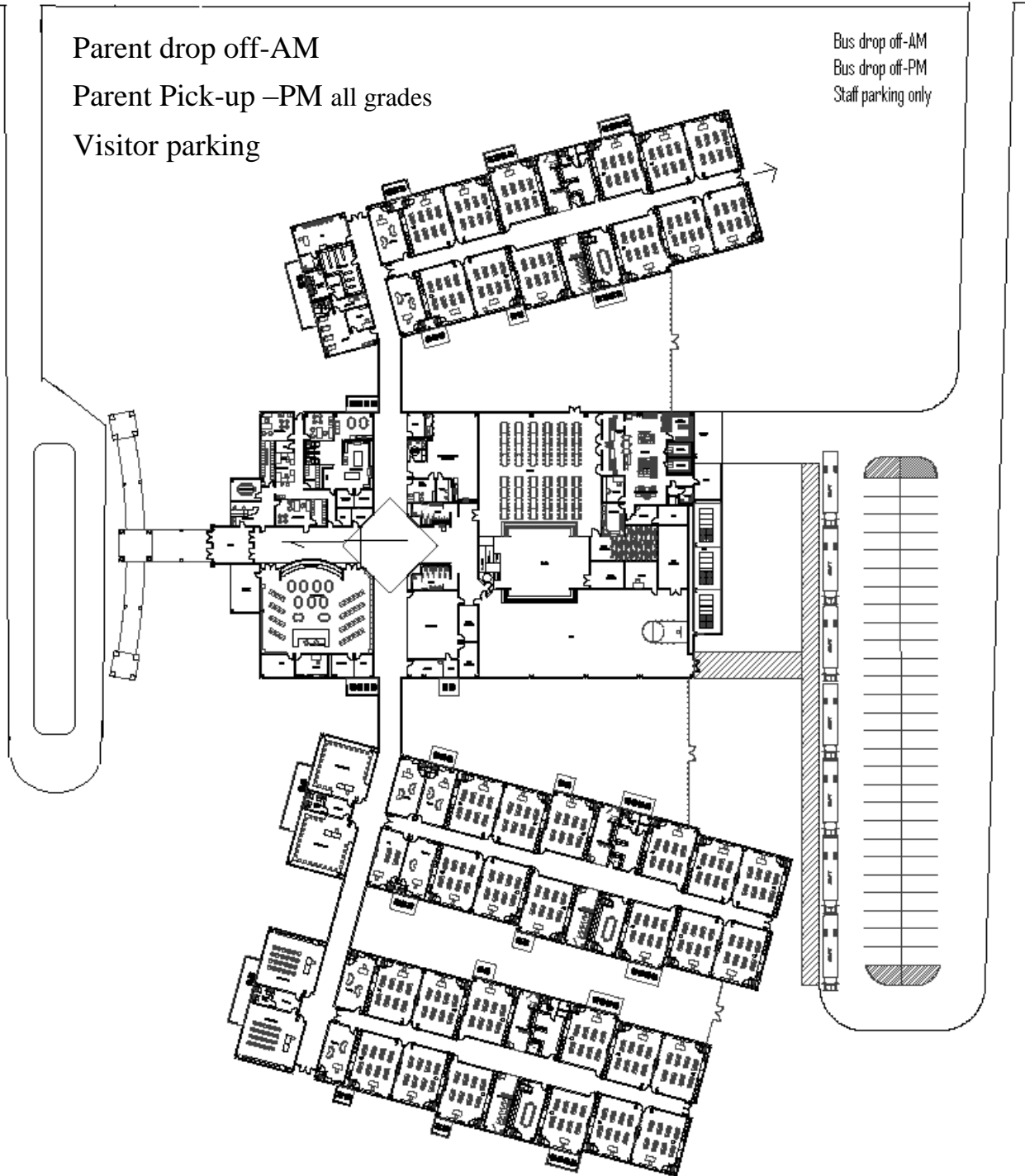

Center Intermediate School

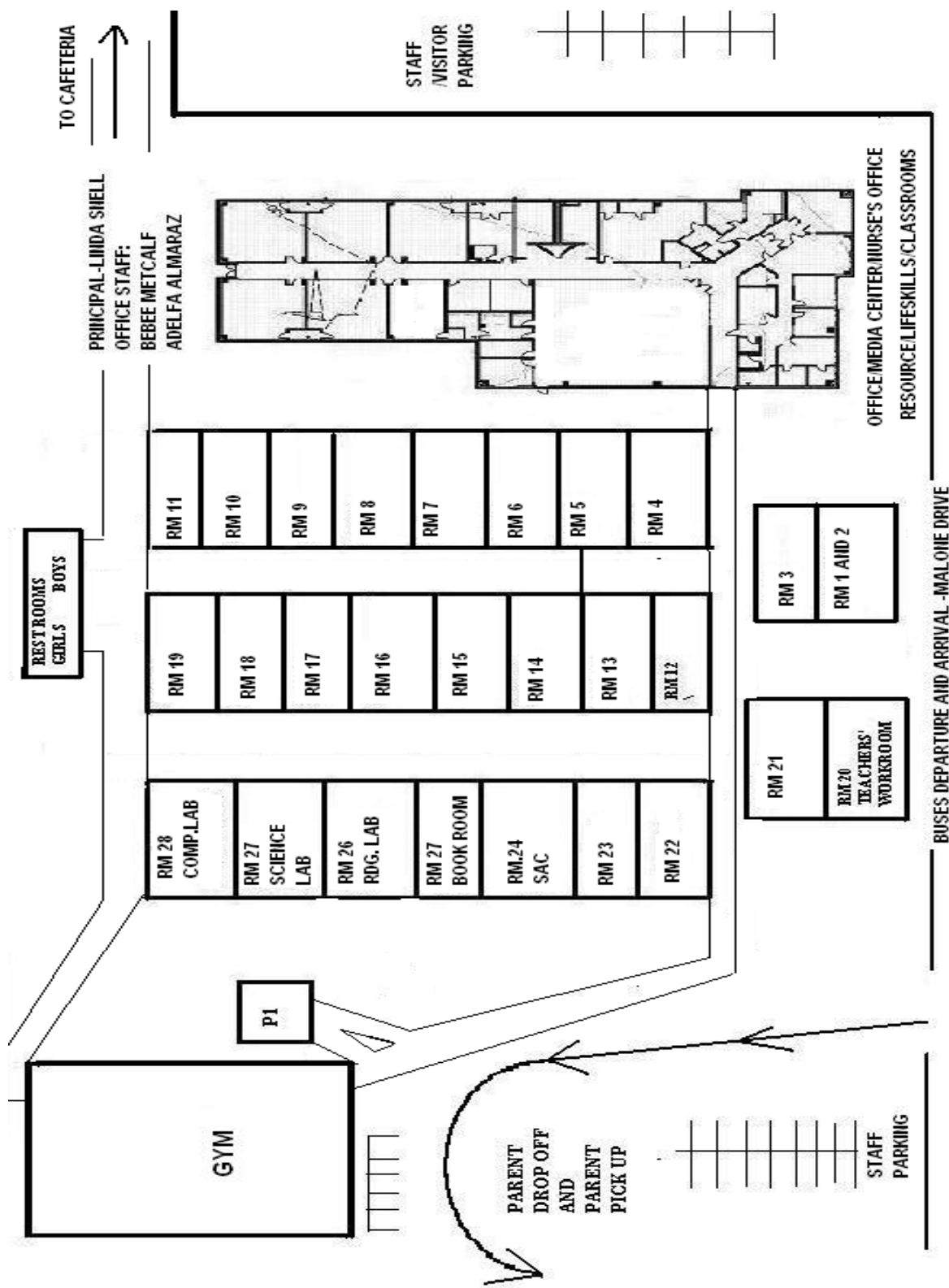

APPENDIX III:

Center Elementary School and F.L. Moffett Primary School Parental Involvement Policy

Center Elementary School seeks to chart a course that will advance the partnership between home and school for the improvement of education of children. In this partnership, we will assure that parents have input into the planning, design, and implementation of the program. Communication with families will be organized, systematic, ongoing, informative, and timely in relation to decisions about the instructional program.

To ensure a family-school partnership that supports the instructional program we will:

1. Inform parents of the instructional program through a comprehensive range of activities, such as, annual meetings, monthly newsletters, letters home, parent meetings, family nights, parent teacher conferences, etc.;
2. Consult with parents on how to work together to meet the program's objectives;
3. Provide parents with timely and meaningful reports on their child's academic progress through parent-teacher conferences, progress reports, report cards, and reasonable access to staff.

To promote two-way communication between families and schools we will:

1. Train principals, teachers, and encourage parents, on building bridges to form home/school partnerships;
2. Offer training to parents to work more effectively with their children;
3. Train school staff to work effectively with parents;
4. Make parents aware of parental involvement policy and requirements in a language the parents understand.
5. Provide conference time for parents to meet with teachers. (scheduled parent conferences time in the fall.)
6. Provide opportunities and training for parent volunteers.

Center Intermediate School Parental Involvement Policy

Center Intermediate School seeks to chart a course that will advance the partnership between home and school for the improvement of education of children. In this partnership, we will assure that parents have input into the planning, design, and implementation of the program. Communication with families will be organized, systematic, ongoing, informative, and timely in relation to decisions about the instructional program.

To ensure a family-school partnership that supports the instructional program we will:

1. Inform parents of the instructional program through a comprehensive range of activities, such as, annual meetings, monthly newsletters, letters home, parent meetings, family nights, parent teacher conferences, etc.;
2. Consult with parents on how to work together to meet the program's objectives;
3. Provide parents with timely and meaningful reports on their child's academic progress through parent-teacher conferences, progress reports, report cards, and reasonable access to staff.

To promote two-way communication between families and schools we will:

1. Provide training for parents, principals, and teachers on building bridges to form home/school partnerships;
2. Encourage parents to work more effectively with their children;
3. Train school staff to work effectively with parents;
4. Make parents aware of parental involvement policy and requirements in a language the parents understand.

District Parent/Family Involvement Policy

Center ISD recognizes that each child's education is a responsibility shared by the school district and the child's family. To support the goal of the school district to effectively educate all students to succeed, the campuses and parents/families must work together as knowledgeable partners.

Although parents/families are diverse in culture, language and needs, they share a common commitment to the educational success of their children. Center ISD and the campuses, in collaboration with parents/families will work towards establishing programs and practices that enhance parent/family involvement and reflect specific needs of students and their families.

To this end, the District supports working towards the development, implementation and regular evaluation of parent involvement programs on each campus and at the district level, which will involve parents/families in the decisions and practices at all grade levels. The parent/family involvement programs to be developed will be comprehensive and coordinated in nature. They will include, but not be limited to, the following components of successful parent involvement programs:

- Communication between home and school should be regular, two-way, and meaningful.
- Parenting skills are promoted and supported.
- Parents/families play an integral role in assisting with student learning.
- Parents/families are welcomed at the campus and district levels and their support and assistance are sought in the decisions that affect their children and families.
- The district and campuses support parents/families in their roles as the child's first and most important teacher.
- Community resources are used to strengthen school, family and student learning.

Center ISD supports the implementation of professional development opportunities for staff members to enhance understanding of effective parent/family involvement strategies. The District also recognizes the importance of administrative leadership in setting expectations and creating a climate that encourages parental participation.

APPENDIX IV:

INFORMATION FOR PARENTS ON THE USE OF CORPORAL PUNISHMENT

1. Parents have the responsibility to notify the principal if they object to the use of corporal punishment. Objections must be signed by the parent and submitted in writing by a date specified by the District. [See Exhibit B]
2. Corporal punishment will be administered only by the principal or another professional employee. [See FO(LOCAL)]
3. Corporal punishment will be administered as soon as possible after an offense and will not be administered in anger.
4. Corporal punishment will be administered in the presence of a witness. [See FO(LOCAL)]
5. The principal or a designee may choose not to use corporal punishment even if the parent has requested its use.
6. Any use of corporal punishment will be documented on a District form. [See Exhibit C]
7. The principal or a designee will inform the parent or guardian when corporal punishment is used.
8. Paddles used for administering corporal punishment will not be generally displayed and will be under the control of the principal or designee.
9. Corporal punishment will be limited to spanking or paddling and will consist of an appropriate number of strikes based upon the size, age, and the physical, mental, and emotional condition of the student.
10. Before corporal punishment is used, the District may give the student a choice between other disciplinary measures and corporal punishment.

APPENDIX V:

Grading Policy 2011-2012 GRADING GUIDELINES Center Elementary/Intermediate School

I. Introduction/Rationale

The campus will develop guidelines for teachers to follow in determining grades for students. These guidelines shall ensure that grading reflects a student's relative mastery of an assignment and that a sufficient number of grades are taken to support the grade average assigned. Guidelines for grading shall be clearly communicated to students and parents.

Promotion and course credit shall be based on mastery of the curriculum. Expectations and standards for promotion shall be established for each grade level, content area and course and shall be coordinated with compensatory and accelerated services.

II. Standards for Mastery (Policy EIE Local)

Assignments, tests, projects, classroom activities and other instructional activities shall be designed so that the student's performance indicates the level of mastery of District curriculum objectives. The student's mastery shall be a major factor in determining the grade for a subject or course.

Course assignments and unit assessments shall be used to determine student grades in a subject with an average grade of 70 or higher to be considered as a passing grade. Credit for a class shall be awarded at the end of each semester if a student has: (1) a grade average of 70 or higher in the class and (2) met all state requirements for attendance.

III. Grade/Progress Reporting (Policy EIA Local)

Grade reports shall be issued every six weeks on student report cards. Progress reports shall be sent home with students after the third week of each six-week grading period. **If a student's grade falls below 70 at any time, the teacher will make every effort to contact the parent/guardian in writing or by phone.**

IV. Grading Procedures

Student achievement shall be based on the degree of mastery of the District's curriculum which is based on the Texas Essential Knowledge and Skills (TEKS). Numerical grades will be recorded and reported with 70 representing mastery of 70% of the required objectives and the minimum passing grade.

Responsibilities of Teachers:

- a) follow the CES/CIS and District guidelines
- b) accurately average grades
- c) accurately record grades for assignments
- d) verify accuracy of peer-graded work
- e) return graded work to students promptly
- f) provide reasonable opportunity for re-teach and retest on objectives not mastered (test and re-test grades will be averaged together)
- g) not increase or decrease a classroom grade for participation or lack of participation in any extracurricular activity

Responsibilities of Students:

- a) complete each assignment within the time limits given by the teacher
- b) evaluate and review their work for accuracy prior to turning it in
- c) seek assistance from the teacher as needed
- d) ask for make-up work following absence(s)

V. Promotion Criteria (policy EIE Local)

Grades 1-5 – Promotion to the next grade level shall be based on an average of 70 on a scale of 100 based on course-level or grade-level standards (TEKS) for all subject areas and a grade of 70 or above in reading and mathematics.

VI. Grade Determination

Assessments must meet the rigor required by the TEKS and will include Center Curriculum Assessments, performance indicator products, teacher-developed assessments and assessments from other approved resources. Each grade level core subject committee will determine the common assessments and assignments to be used.

Modifications/Accommodations on assessments are noted on the report card and assignment.

Grade percentage breakdown is as follows:

(CES)Assessments (unit assessments, teacher developed assessments, quizzes, classroom Tests and PI) = 60%

Daily work/Class work = 40%

(CIS) Assessments (unit assessments, quizzes, teacher-made assessments) must meet the rigor required by the TEKS and will be recorded as test grades. Assessment grades will be weighted 60% and other assignment grades will be weighted 40%.

Each core subject area will have the following minimum number of grades each six weeks:

(CES)ELA (Reading, Phonics, Writing, Grammar) – 20 (CIS-12 two grades per week)

(CES)Math – 10 (CIS-12 two grades per week)

(CES/CIS)Social Studies – 6 (one grade per week)

(CES/CIS)Science – 6 (one grade per week)

The six-week average for ELA will be based on 60% Reading and 40% Writing, Phonics Spelling and Grammar.

Extra Credit – The intent of extra credit is for enrichment in a class and to gain mastery of the TEKS objectives. If extra credit is offered, it should be academic, offered to all students in a class, and count no more than 5% of a student’s total six weeks grade.

Cheating/Plagiarism/Academic Dishonesty – Copying another student’s work or permitting work to be copied by another student will result in a zero for the student(s)

Late work – Late work will be due one day following the original due date of the assignment with a 25% reduction on the grade. Late work will not be accepted beyond the one day requirement. A student will receive a zero for any work not turned in during the required time.

Make-up work – Make-up work for excused absences shall be made available to all students. Make-up work shall provide the student with sufficient opportunity to master the TEKS or subject area requirements and shall be based on instructional objectives of the course. Students are responsible for asking for make-up work upon return to class. The number of days allowed for completion of make-up work shall be equal to the number of days missed. In the event of an extended absence, other arrangements approved by campus administration may be made. Any assignments not turned in during the allotted time will follow late work guidelines. Students will not be required to take an exam or turn in an assignment on the day of returning to school if the test or assignment was assigned during the student’s absence. Make-up work may be a revised version of the original assignment. Students eligible to attend Content Mastery must be allowed to attend Content Mastery for make-up work assistance.

Unexcused absence – A student with an unexcused absence may make up all work missed, but shall receive a 25% reduction in any grade(s). Students shall receive a zero for any assignment or test not made up within the allotted time.

Suspension – A student suspended from his or her regular classes may make up work, but will receive a 25% reduction in grade(s). Students shall receive a zero for any assignment or test not made up within the allotted time.

Incomplete Grades – Unusual circumstances may occur which cause a student to be unable to complete coursework/assignments by the end of a grading period. In such cases, the student may receive an “Incomplete” for that grading period. The student will have a minimum of one week upon his/her return to complete the assigned work. In unusual cases where the student has missed a quantity of work, the time may be extended. In all cases, the teacher must communicate to the student and parents the nature of the outstanding work and the time limitation for completing the work.

School Related Absences – Students are responsible for work/assignments missed when they are out due to school related activities. The number of days allowed for completion of make-up work shall be equal to the number of days missed for the activity.

Student Transfers (Policy EIC Local) – If a student transfers into the school from a school that uses letter grades, use the following conversion chart to assign grades:

95=A
85=B
75=C
70=D
60 =F

VII. Types of Assessments/Assignments

Class work – Class work is any instructional activity defined/planned by the teacher to be completed during a class period to facilitate the learning process. There may be occasions where class work becomes homework, which may include guided or independent practice.

Homework – Homework may be a necessary part of the instructional process that begins in the classroom, extends into the home, and provides a way for parents to become aware of the instructional program and their child’s educational program. **Homework should never be a disciplinary measure.**

Quizzes/ Skill Checks – Quizzes and Skills Checks are short assessments designed by the teacher to evaluate a student’s level of understanding and progress toward unit objectives. These assessments do not have to be scheduled in advance.

Examinations – Examinations are assessments designed to measure a student’s level of mastery of the TEKS. Major examinations or tests are considered to be a chapter, unit concept(s), or cumulative (weekly, three or six weeks) tests. Major tests shall be scheduled and announced in advance.

Alternative Assessments – Alternative assessments will be a meaningful measure of real world tasks. The performance/product shall be at the level of rigor as curriculum performance indicators. This type of assessment often requires analyzing a task, developing a plan of action, gathering information, selecting the relevant information, and presenting appropriate information. The method of performance/product shall be designed by the teacher based on the subject area and content objectives. Alternative assessments may be substituted for examinations.

Research Paper/Projects – Research papers or projects are long-term assignments that may involve both class work and homework. Teachers may assign research papers or projects to an individual or to a group of students. Teachers will inform students of the research paper/project requirements and grading guidelines well in advance of the due date. **Students, who are absent on the due date, including school business, must meet the deadline.** Grades for each group member should not be affected by another group member’s non-participation. Conversely, a student who does not fully participate, but participates to a limited degree, will receive a grade appropriate to his/her participation.